

# NT2400 NT Typ/NT Type

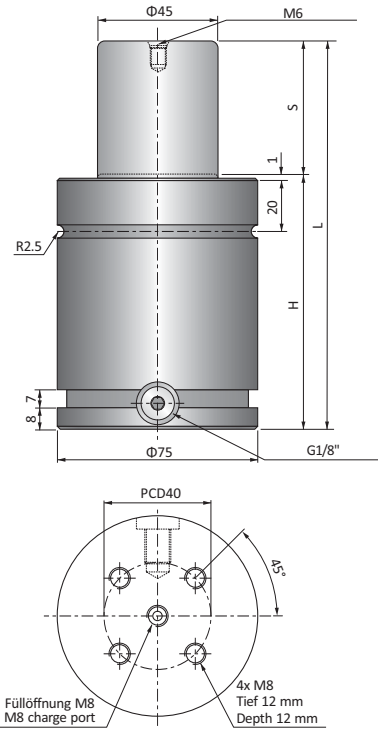

## Super Compact Gasdruckfedern Super Compact Cylinders

Der Typ NT hat die gleichen Eigenschaften wie der Typ N und weist die niedrigste Bauhöhe bei jeweils gleichem Zylinderdurchmesser auf. Eignet sich zur Minimierung der Werkzeughöhe und besitzt ab NT1000 einen Schlauchanschluss.  
Zylinderdurchmesser von 19 mm (170 daN) bis 150 mm (9500 daN).

NT type has same characteristics with N type and has shortest height among same size cylinders, suitable to minimize the tooling height and able to hose connection from NT1000.  
The size starts from 19 mm (170 daN) to 150 mm (9500 daN).

CODE	S	H	L	Anfangskraft Initial Force (daN)	Endkraft Final Force (daN)
NT2400-16	16	61	77	2400	3800
NT2400-19	19	64	83		
NT2400-25	25	70	95		
NT2400-32	32	77	109		
NT2400-38	38	83	121		
NT2400-50	50	95	145		
NT2400-63	63	108	171		
NT2400-75	75	120	195		
NT2400-80	80	125	205		
NT2400-100	100	145	245		
NT2400-125	125	170	295		

Mit Schlauchanschluss verfügbar  
Available Hose-connection

## Federkraft-Hub-Diagramm Spring Force - Stroke Diagram

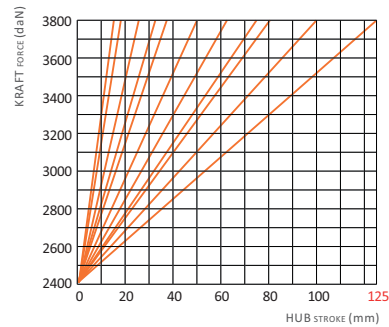

## Bestellcode Ordering

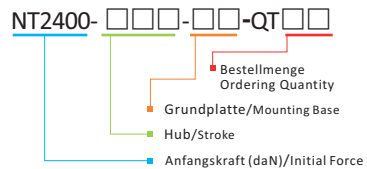

NT2400-050-BS-QT04

# NT2400 Einbaubeispiel/ Befestigungsvarianten(Mounting Bases)

## BH-2400

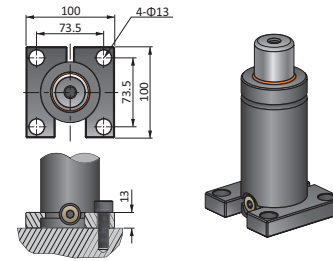

## BS-2400

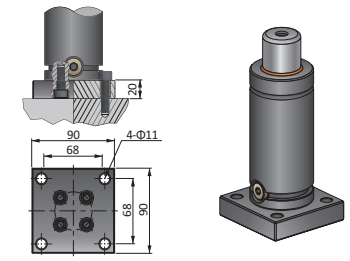

## CBS-2400

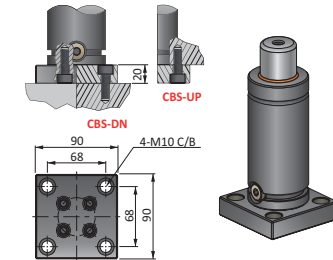

## BC-2400

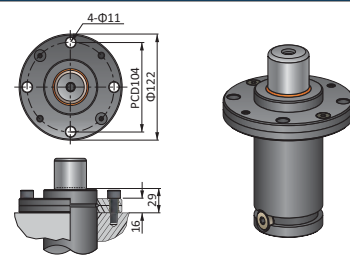

## BP-2400NT

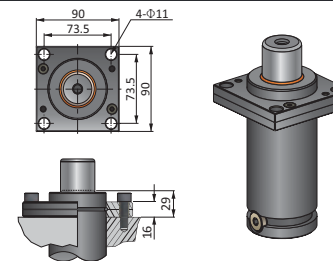

## BF-BB-2400

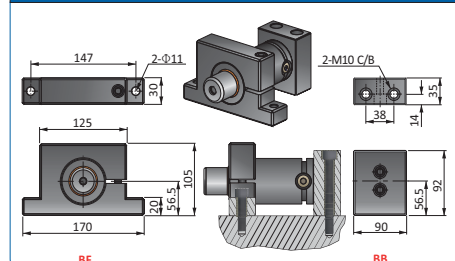

# NTT2400 NTT Typ/NTT Type

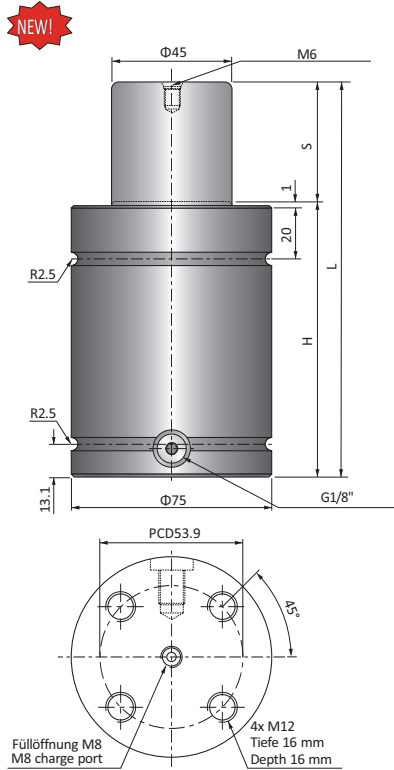

## Super Compact Gasdruckfedern Super Compact Cylinders

Der Typ NTT hat die gleichen Eigenschaften wie der Typ NT, weist aber für eine sicherere Befestigung größere Gewinde mit einer Tiefe von 16 mm auf. Schlauchanschluss erhältlich ab NTT1000. Zylinderdurchmesser von 32 mm (350 daN) bis 150 mm (9500 daN).

NTT type has same characteristics as NT type but has bigger tap size and 16 mm thread dept for more secure mounting. Available hose connection from NTT1000. The size starts from 32 mm (350 daN) to 150 mm (9500 daN).

CODE	S	H	L	Anfangskraft Initial Force (daN)	Endkraft Final Force (daN)
NTT2400-16	16	75	91	2400	3800
NTT2400-19	19	78	97		
NTT2400-25	25	84	109		
NTT2400-32	32	91	123		
NTT2400-38	38	97	135		
NTT2400-50	50	109	159		
NTT2400-63	63	122	185		
NTT2400-75	75	134	209		
NTT2400-80	80	139	219		
NTT2400-100	100	159	259		
NTT2400-125	125	184	309		

Mit Schlauchanschluss verfügbar  
Available Hose-connection

### Bestellcode Ordering

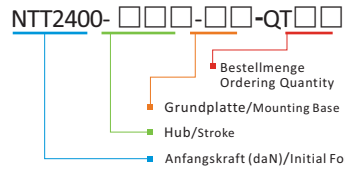

NTT2400-050-BP-QT04

### Federkraft-Hub-Diagramm Spring Force - Stroke Diagram

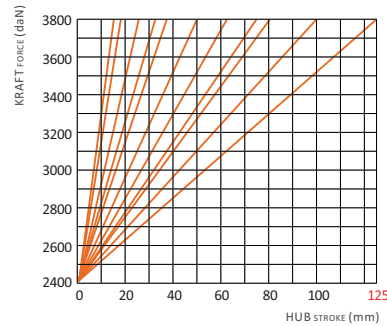

# NTT2400 Einbaubeispiel/ Befestigungsvarianten(Mounting Bases)

## CBL-2400NTT

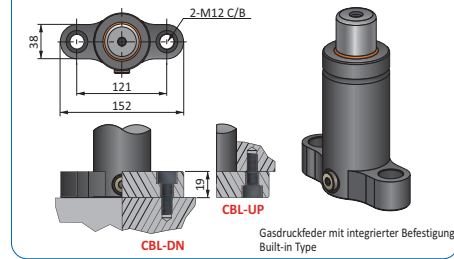

## BC-2400NTT

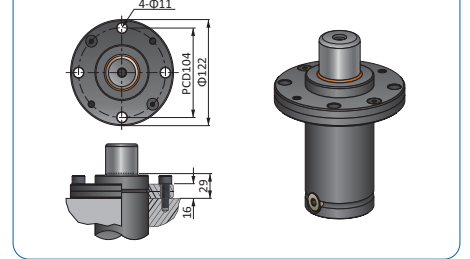

## LBP-2400NTT

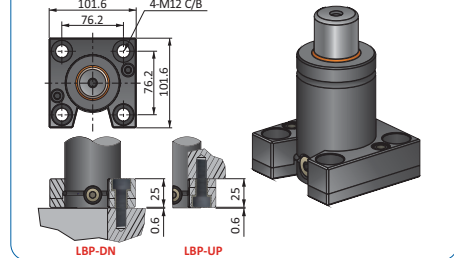

## BP-2400NTT

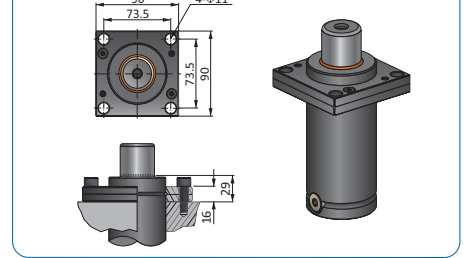

## BK-2400NTT

