

**SZ-YBTA**

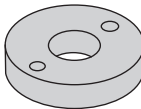

Bohrungen  
PD=30-60:2 Screw holes

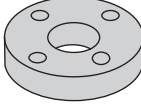

Bohrungen  
PD=80-100:4 Screw holes

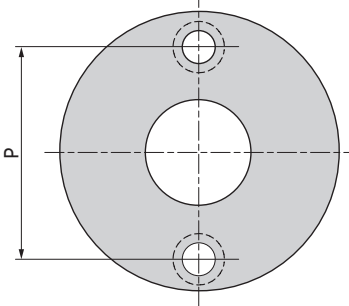

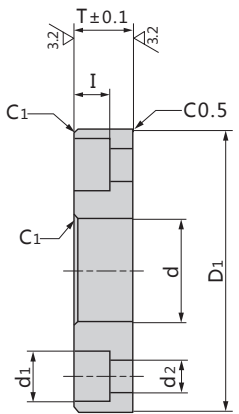

T	Schraubenlänge screw length
20	25
25	30
30	35
35	40
40	45
45	50
50	55
55	60

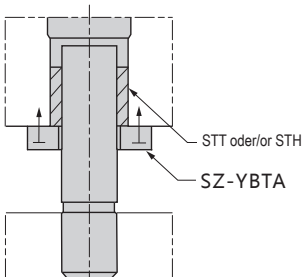

Material:Stahl  
Material:Steel

Katalog-Nr. / Catalog No.		PD	D <sub>2</sub>	D <sub>1</sub>	d	P	I	d <sub>1</sub>	d <sub>2</sub>	T	Farbe Color
Typ	PD										
SZ-YBTA	30	30	50	96	35	72	15 (T=20, I=12)	17.5	11	20-55	R (rot) R(Red) Y (gelb) Y (Yellow) N (normal) N(Normal)
	40	40	60	106	45	82					
	50	50	70	116	55	92					
	60	60	80	126	65	102		20	14		
	80	80	100	150	85	124					
	100	100	120	170	105	144					

**Bestellnummer / Order Number**

	Bestellung Order	Katalog-Nr. / Catalog No. <b>SZ-YBTA 50</b>	-	T <b>25</b>	-	Farbe / Color <b>Y</b>
---	---------------------	--	---	----------------	---	---------------------------



**SZC**

**Produktmerkmale:**  
 Führungssäulen SZC zum Einpressen sind geeignet für selbstschmierende Buchsen ohne Bund (STT und STH).

**Product Features:**  
 Press Fit Guide Post SZC are suited for Straight Self-Lubricating Bushings (STT and STH).

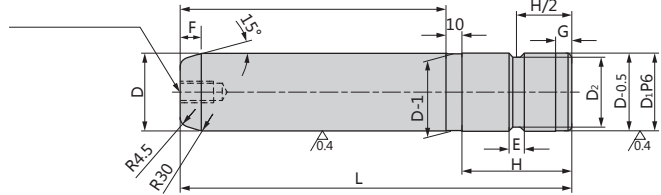

**Material:Stahl**      **Material:Steel**  
**Härte: HRC55-60**    **Heat treatment: HRC55-60**

D	Toleranz / Tolerance	D <sub>1</sub>	P6	D <sub>2</sub>	H	G	F	E	Katalog-Nr. / Catalog No.	D	L
25		25	P6	21	30				SZC	25	80
										100	120
										140	160
										180	200
30	-0.005 -0.015	30	+0.035 +0.022	26	40	5	5	8	SZC	30	100
										120	140
										160	180
										200	250
40		40	+0.042 +0.026	36	50				SZC	40	120
										140	160
										180	200
										250	300
50		50	+0.051 +0.032	45	70			10	SZC	50	160
										180	200
										250	300
										350	400
60	-0.010 -0.020	60	+0.051 +0.032	55	90	10	10		SZC	60	200
										250	300
										350	400
										450	500
80	-0.010 -0.025	80	+0.059 +0.037	75	120			12	SZC	80	250
										300	350
										400	450
										500	600
100		100	+0.059 +0.037	95	150				SZC	100	300
										350	400
										450	500
										600	700

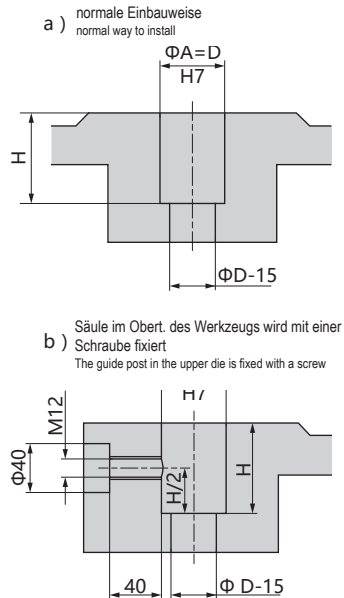
**Einbauhinweise:**

**Bestellnummer / Order Number**

Bestellung Order      **Katalog-Nr. / Catalog No.**      **D - L**

**SZC      50 - 250**

**Optional:**  
 Bestellzusatz MP: Befestigungsgewinde

**Option order:**  
 Specification order MP: Mounting thread

·Specification MP

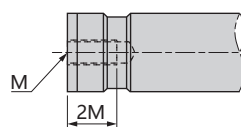

D	M
25	8
30 · 40	10
50 · 60	12
80 · 100	16

**Bestellnummer / Order Number**

Bestellung Order      **Katalog-Nr. / Catalog No.** - **D** - **L<sub>1</sub>**  
**SZC      - 25 - Y**





### STT

(Bronze / Bronze)

### STH

(Gusseisen / Cast Iron)

**Produktmerkmale:**  
Selbstschmierende Buchsen ohne Bund (STT und STH) eignen sich für Führungssäulen zum Einpressen SZC.

**Product Features:**  
Straight Self-Lubricating Bushings (STT and STH) are suited for Press Fit Guide Posts SZC .

**Material:**  
STT Bronze+Graphit  
STH HT300+Graphite

**Material:**  
STT Bronze+Graphit  
STH HT300+Graphite

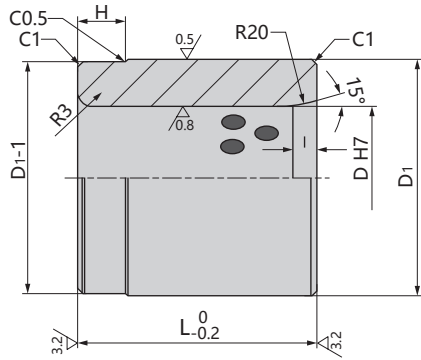

Dh7	D <sub>1</sub> Toleranz / Tolerance	L	H	I	F	Katalog-Nr. / Catalog No.	D	
30	+0.021 0	50	±0.008	50	10	5	130	30
40	+0.025 0	60	±0.0095	60	10	10	140	40
50		70		75	15		150	50
60	+0.030 0	80	±0.011	90	20	10	160	60
80		100		120	25		180	80
100	+0.035 0	120		150			200	100

### Einbaubeispiel

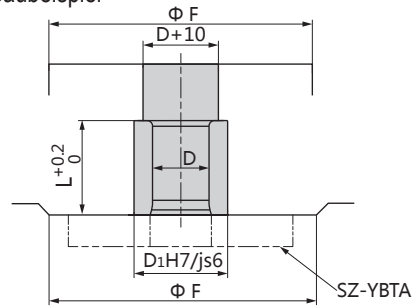

### Bestellnummer / Order Number



Bestellung  
Order

Katalog-Nr. / Catalog No.

- D

STT  
STH

- 50  
- 50

### Optional:

Bestellzusatz DQ:  
Lieferung mit Schrauben und Scheiben

Option order:  
Specification order DQ:  
Delivery with screws and washers

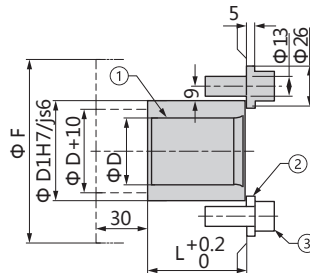

- ① Buchse/bushing SST oder/or STH 1x
- ② Scheibe/washer SZ-DQA24 2x
- ③ Schraube/screw M12 x 30 2x

### Bestellnummer / Order Number



Bestellung  
Order

Katalog-Nr. / Catalog No.

- D

STT  
STH

- 50  
- 50

