

KACG50

**Tabelle Schieber
Table of Cam Structure**

Bestellnr. / Catalog No.	W	X ₁	X ₂	X ₃	Z ₁	Z ₂	Z ₃	Gewicht (kg) / Weight (kg)
KACG50-00	50	195.00	80	72.5	180	67.50	46.0	10.6
KACG50-05	50	198.04	75	72.5	180	68.29	52.4	10.3
KACG50-10	50	195.99	65	72.5	180	69.77	58.6	9.9
KACG50-15	50	198.77	65	72.5	180	71.95	64.5	9.7
KACG50-20	50	196.34	55	72.5	180	74.79	70.1	9.4
KACG50-25	50	191.62	41	72.5	180	80.28	73.3	9.4
KACG50-30	50	190.58	40	62.5	180	85.39	77.0	9.2
KACG50-35	50	187.15	25	72.5	180	90.10	81.3	9.2
KACG50-40	50	183.29	22.5	62.5	180	95.35	85.1	9.1
KACG50-45	50	179.94	10	72.5	180	98.13	91.4	9.1
KACG50-50	50	174.07	5	72.5	180	99.37	99.2	9.0
KACG50-55	50	168.64	-15	72.5	180	111.04	96.4	9.5
KACG50-60	50	162.61	-25	72.5	180	118.08	98.0	9.7
KACG50-65	50	155.95	-35	72.5	180	125.44	99.0	10.0

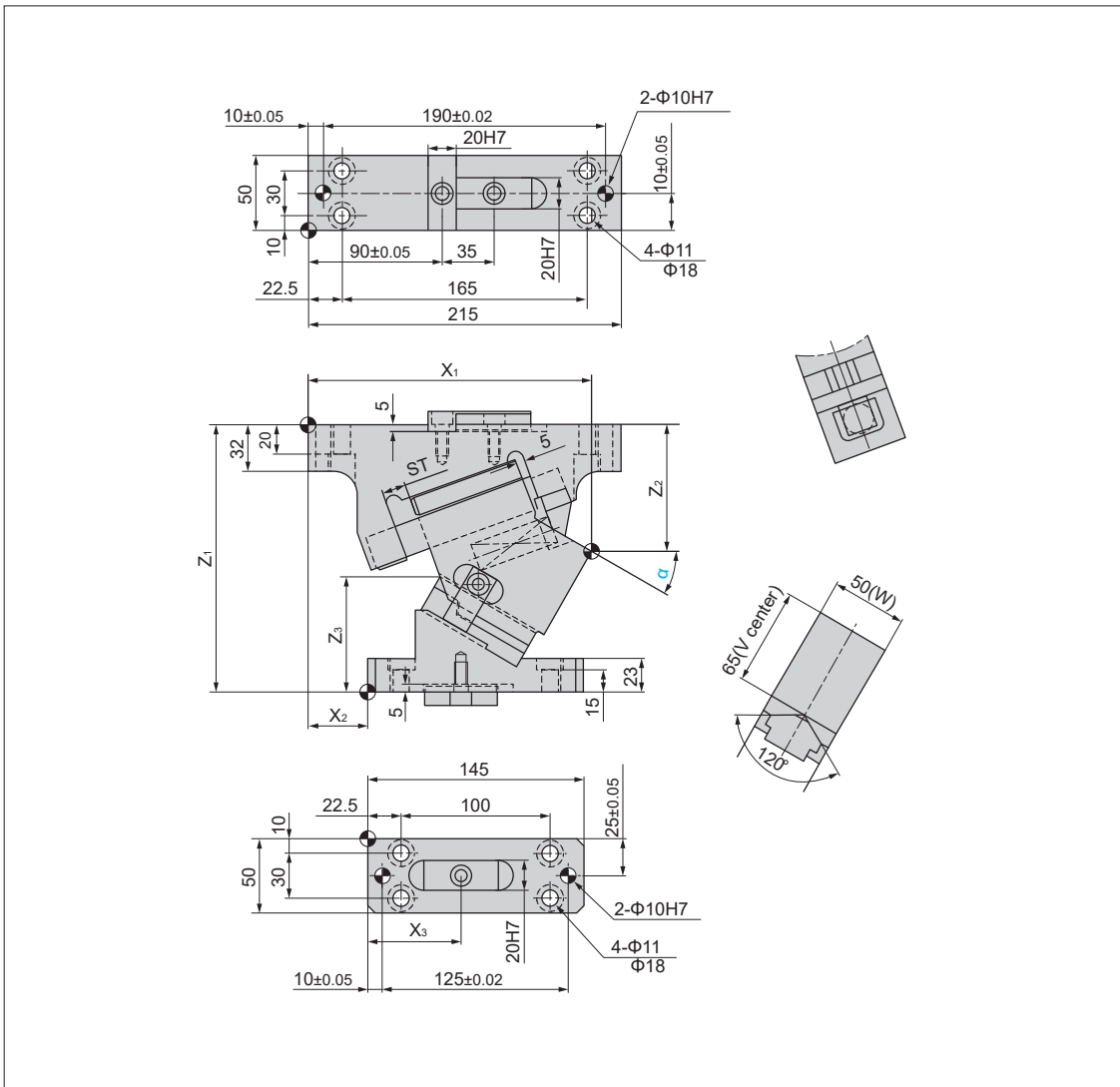

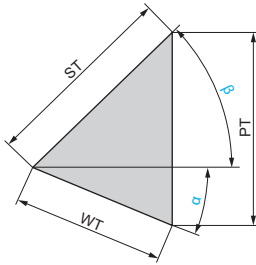

Bestellnr. / Catalog No.	α	β	WT	ST	PT
KACG50-00	0	50	15.0	23.3	17.8
KACG50-05	5	45	15.6	22	16.9
KACG50-10	10	40	15.6	20	15.6
KACG50-15	15	35	17.0	20	15.9
KACG50-20	20	30	18.4	20	16.3
KACG50-25	25	25	18.0	18	15.2
KACG50-30	30	20	17.4	16	14.2
KACG50-35	35	15	18.9	16	15.0
KACG50-40	40	10	20.6	16	16.0
KACG50-45	45	5	22.5	16	17.3
KACG50-50	50	0	23.3	15	17.9
KACG50-55	55	-5	26.1	15	20.0
KACG50-60	60	-10	31.5	16	24.5
KACG50-65	65	-15	36.6	16	29

Übersicht Schieberkraft / Rückzugskraft
Table of Cam Force

Typ / Type	α	Modell / Model	Federkraft (N/kgf) / Spring Force (N / kgf)		Arbeitskraft (kN / tonF) / (kN / tonF) Work Force	
			Anfangskraft / Initial Load	Endkraft / Final Load	1 Mio. Hübe / strokes Standard-Arbeitskraft / Standard Working Force	300.000 Hübe / strokes Zulässige Arbeitskraft / Allowable Working Force
Schraubendruckfeder / Coil Spring	00°	TJH20-102	184.2 / 18.8	1097.6 / 111.7	29.4 / 3.0	58.8 / 6.0
	05°	TJH20-89	179.6 / 18.3	1167.4 / 118.8		
	10° ~ 20°		269.4 / 27.4			
	25°		359.2 / 36.6			
	30° ~ 45°		263.0 / 26.8			
	50° ~ 55°	TJH20-76	315.6 / 32.2	1104.6 / 112.6		
60° ~ 65°	TJH20-76	263.0 / 26.8	1104.6 / 112.6			

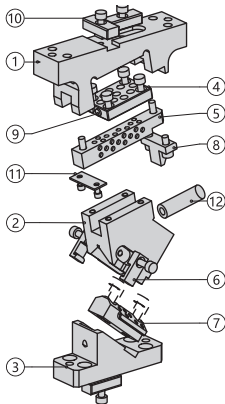

Nr. / No.	Beschreibung / Description	Anzahl / Qty	Material und Anmerkung / Material and Remark
①	Aufnahme / Cam Holder	1	QT450
②	Schieber / Cam Slider	1	QT450
③	Treiber / Cam Driver	1	QT450
④	Gleitplatte / Guide Block	1	QT450+Festschmierstoff / graphite plugs
⑤	Führungsleiste / Guide Rod	1	Bronze+Festschmierstoff / graphite plugs
⑥	Zwangsrückführung / Positive Return Follower	2	St45
⑦	V-Prisma / V Cam Slide Guide	1	Bronze+Festschmierstoff / graphite plugs
⑧	Federblock / Spring Block	1	St45
⑨	Urethan-Dämpfer / Urethane Stopper	2	Urethan
⑩	Passfeder / Key	3	St45
⑪	Sicherungsplatte / Safety FMate	1	Stahl 20
⑫	Feder / Spring	1	Typ / Type

Options-Code / Option Code	Beschreibung / Envelope
K	metrische Passfeder ist montiert / A metric key is attached
KA	metrische T-Passfeder an Aufnahme und Treiber montiert / Metric dedicated key is attached for both cam holder and driver.
N13	Stiftlöcher in Aufnahme und Treiber auf $\Phi 13H7$ geändert / Dowel pin holes of cam holder and cam driver are change to $\Phi 13$.

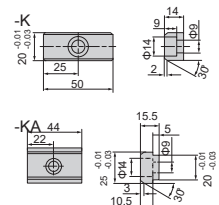
Ausführung Passfeder /
Key specification

Bestellnummer / Order Number

☎	Bestellnr. / Catalog No.	-	(W)	-	(α)
	KACG	-	50	-	30
	KACG	-	50	-	30 - K

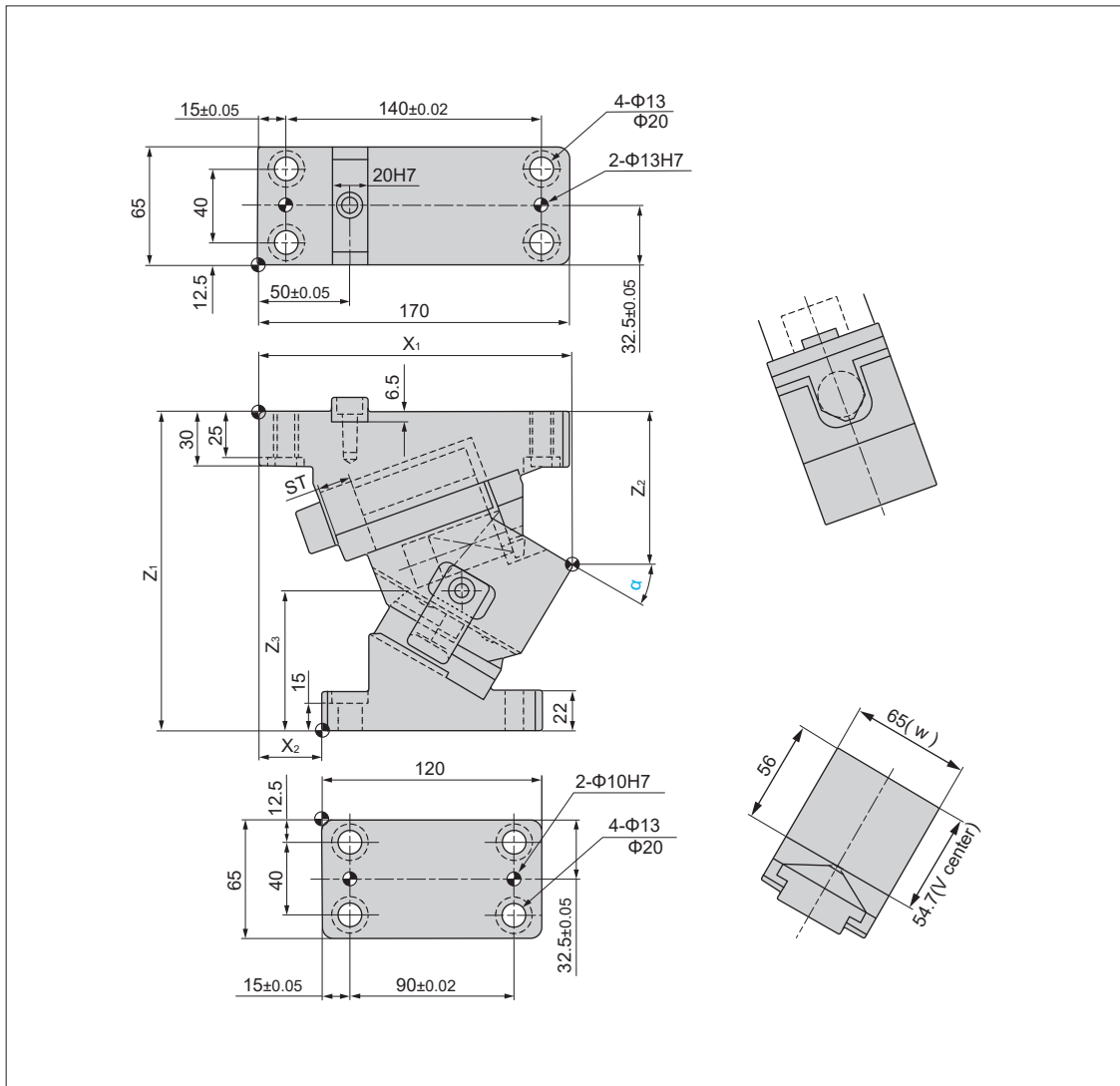

KACG65

**Tabelle Schieber
Table of Cam Structure**

Bestellnr. / Catalog No.	W	X ₁	X ₂	Z ₁	Z ₂	Z ₃	Gewicht (kg) / Weight (kg)
KACG65-00	65	170.00	70	175	60.00	58.0	10.7
KACG65-05	65	170.36	65	175	67.22	57.1	10.4
KACG65-10	65	175.07	62.5	175	69.88	61.1	10.2
KACG65-15	65	174.09	55.0	175	72.92	65.3	9.9
KACG65-20	65	172.40	45.0	175	76.28	70.2	9.9
KACG65-30	65	171.78	35.0	175	83.71	78.1	9.6
KACG65-40	65	163.07	20.0	175	91.63	84.5	9.5
KACG65-50	65	170.00	5.0	175	104.50	91.1	9.9
KACG65-60	65	146.29	-15.0	175	116.78	103.1	11.1

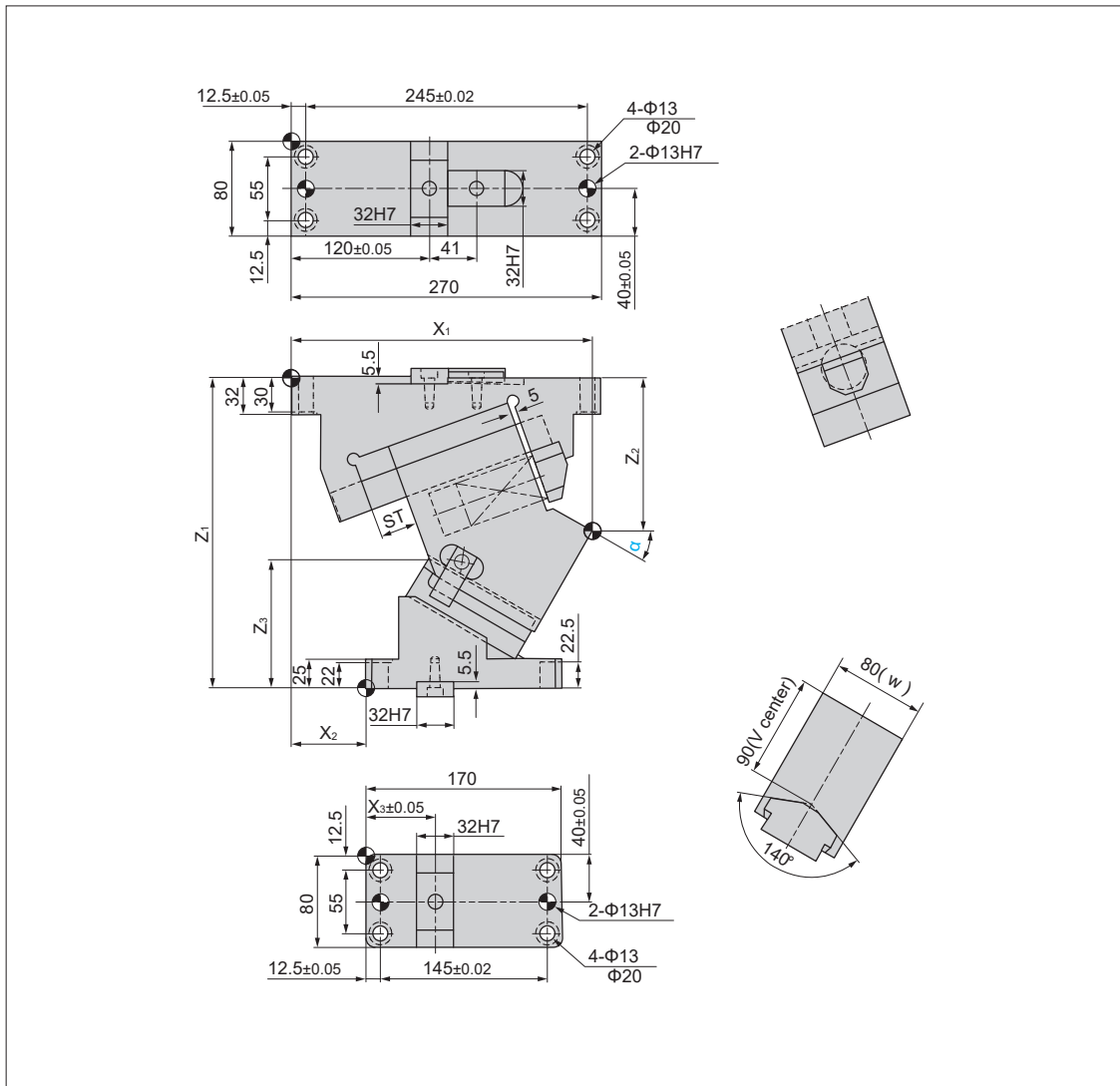

KACG80

**Tabelle Schieber
Table of Cam Structure**

Bestellnr. / Catalog No.	W	X ₁	X ₂	X ₃	Z ₁	Z ₂	Z ₃	Gewicht (kg) / Weight (kg)
KACG80-00	80	277.00	135	65	270	110.00	68.0	34.0
KACG80-05	80	278.32	125	65	270	115.67	72.4	32.0
KACG80-10	80	274.54	110	65	270	117.32	81.5	32.0
KACG80-15	80	277.58	105	55	270	119.95	90.2	32.0
KACG80-20	80	273.34	95	55	270	123.52	98.3	32.0
KACG80-25	80	268.75	80	55	270	128.03	105.9	30.0
KACG80-30	80	261.73	65	60	270	133.42	112.9	30.0
KACG80-35	80	258.20	55	60	270	139.66	119.2	30.0
KACG80-40	80	245.09	35	50	270	146.70	124.8	29.0
KACG80-45	80	245.34	30	50	270	154.49	129.7	29.0
KACG80-50	80	225.87	5	50	270	162.97	133.7	30.0
KACG80-55	80	229.64	0	60	270	172.07	136.9	30.0
KACG80-60	80	208.58	-20	50	270	181.73	139.3	31.0
KACG80-65	80	203.67	-30	50	270	191.87	140.8	32.0

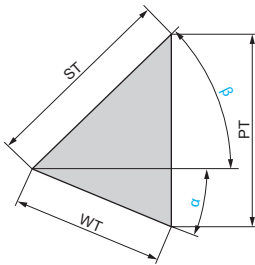



Bestellnr. / Catalog No.	α	β	WT	ST	PT
KACG80-00	0	50	30.2	47	36.0
KACG80-05	5	45	30.5	43	33.1
KACG80-10	10	40	31.1	40	31.1
KACG80-15	15	35	33.9	40	31.7
KACG80-20	20	30	32.3	35	28.5
KACG80-25	25	25	35.0	35	29.6
KACG80-30	30	20	34.7	32	28.3
KACG80-35	35	15	37.7	32	29.9
KACG80-40	40	10	39.9	31	31.0
KACG80-45	45	5	43.7	31	33.6
KACG80-50	50	0	46.7	30	35.8
KACG80-55	55	-5	53.8	31	41.4
KACG80-60	60	-10	61.1	31	47.5
KACG80-65	65	-15	70.9	31	56.2

Übersicht Schieberkraft / Rückzugskraft
Table of Cam Force

Typ / Type	α	Modell / Model	Federkraft (N/kgf) / Spring Force (N / kgf)		Arbeitskraft (kN / tonF) / (kN / tonF) Work Force	
			Anfangskraft / Initial Load	Endkraft / Final Load	1 Mio. Hübe / strokes Standard-Arbeitskraft / Standard Working Force	300.000 Hübe / strokes Zulässige Arbeitskraft / Allowable Working Force
Schraubendruckfeder / Coil Spring	00°	TJL40-152	296.1 / 30.2	1842.4 / 187.6	49.0 / 5.0	98.0 / 10.0
	05°	TJL40-139	324.0 / 33.0	1872.0 / 190.8		
	10° ~ 15°		432.0 / 34.0			
	20° ~ 25°	TJL40-115	391.5 / 39.9	1914.0 / 194.9		
	30° ~ 35°		522.0 / 53.2			
	40° ~ 45°		565.5 / 57.6			
	50°		609.0 / 62.0			
	55° ~ 65°		565.5 / 57.6			

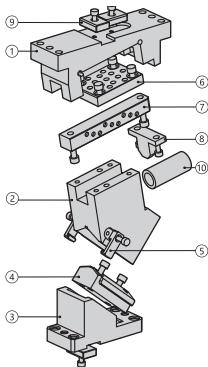

Nr. / No.	Beschreibung / Description	Anzahl / Qty	Material und Anmerkung / Material and Remark
①	Aufnahme / Cam Holder	1	QT450
②	Schieber / Cam Slider	1	QT450
③	Treiber / Cam Driver	1	QT450
④	V-Prisma / V Guide Block	1	Bronze+Festschmierstoff / graphite plugs
⑤	Zwangsrückführung / Positive Return Follower	2	St45
⑥	Gleitplatte / Guide Block	1	Bronze+Festschmierstoff / graphite plugs
⑦	Führungsleiste / Guide Rod	1	Stahl 45+Festschmierstoff / graphite plugs
⑧	Federblock / Spring Block	1	St45
⑨	Passfeder / Key	3	St45
⑩	Feder / Spring	1	Typ / Type

Options-Code / Option Code	Beschreibung / Envelope
K	metrische Passfeder ist montiert / A metric key is attached
KA	metrische T-Passfeder an Aufnahme und Treiber montiert / Metric dedicated key is attached for both cam holder and driver.
N12	Stiftlöcher in Aufnahme und Treiber auf Φ12 geändert / Dowel pin holes of cam holder and cam driver are change to Φ12.

Bestellnummer / Order Number

☎	Bestellnr. / Catalog No.	(W)	(α)
	KACG	80	30
	KACG	80	30 - K

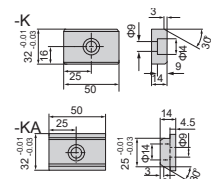
**Ausführung Passfeder /
Key specification**

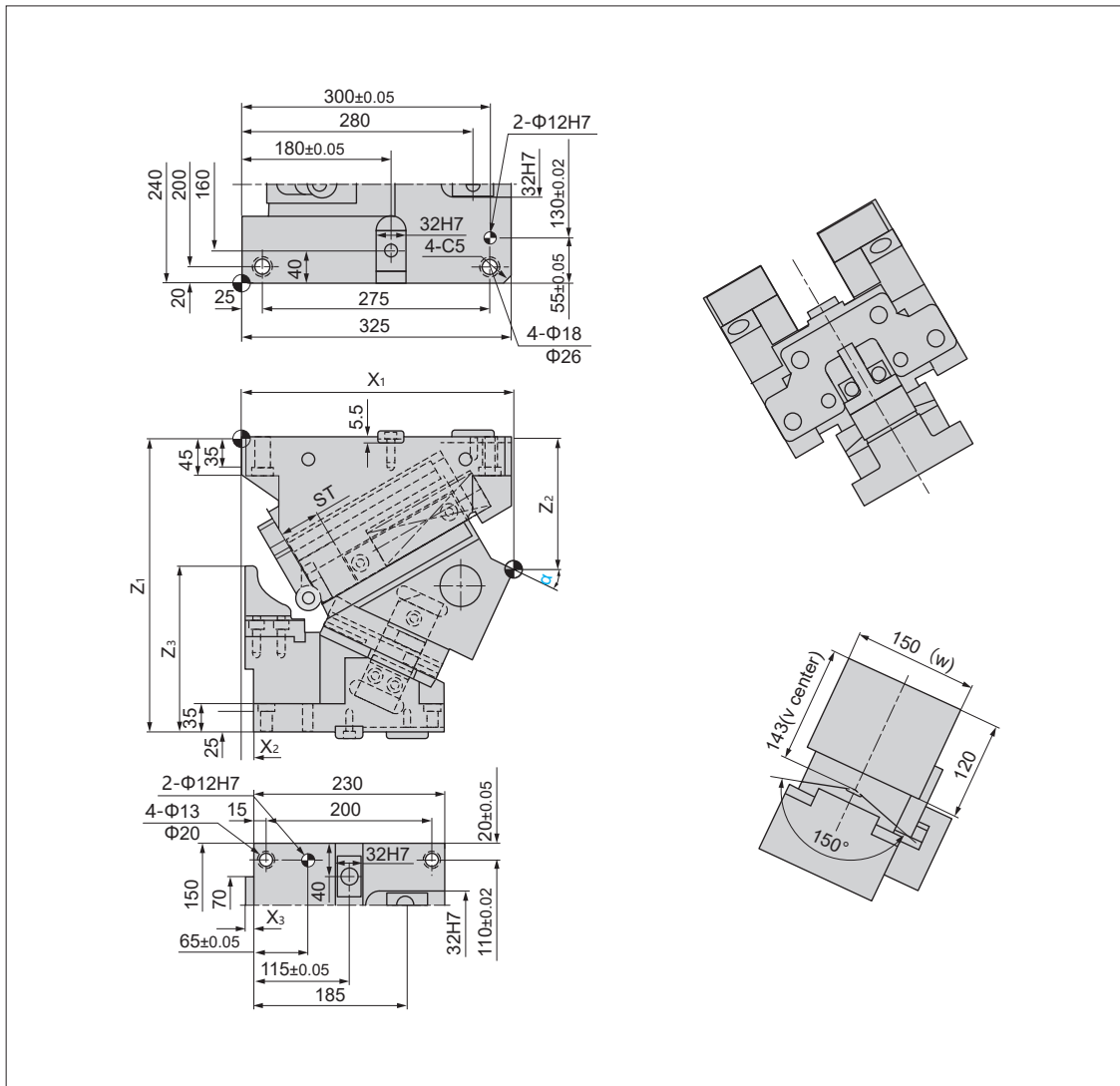
KACG150

**Tabelle Schieber
Table of Cam Structure**

Bestellnr. / Catalog No.	W	X ₁	X ₂	X ₃	Z ₁	Z ₂	Z ₃	Gewicht (kg) / Weight (kg)
KACG150-00	150	325.00	80	25	355	130.00	105	117.6
KACG150-05	150	319.70	60	25	355	133.26	125	114.0
KACG150-10	150	319.06	45	25	355	137.79	145	113.4
KACG150-15	150	322.98	35	20	355	143.56	160	111.9
KACG 150-20	150	326.33	25	15	355	150.51	180	111.3
KACG 150-25	150	329.03	15	10	355	158.61	200	111.2
KACG 150-30	150	325.98	0	0	355	167.78	215	110.2
KACG 150-35	150	322.08	-15	0	355	192.95	220	113.1
KACG 150-40	150	312.26	-35	0	355	204.06	240	114.7
KACG 150-45	150	306.42	-50	0	355	216.01	260	115.8
KACG 150-50	150	294.51	-70	0	355	228.71	280	117.5
KACG 150-55	150	281.46	-90	0	355	242.07	295	117.5
KACG 150-60	150	272.22	-105	0	355	255.98	315	122.0
KACG 150-65	150	261.75	-120	0	355	270.34	340	126.0

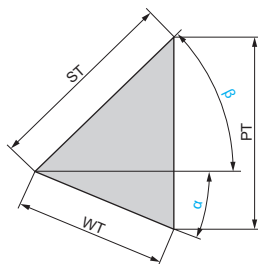



Bestellnr. / Catalog No.	α	β	WT	ST	PT
KACG150-00	0	55	28.6	50	40.9
KACG150-05	5	50	32.2	50	41.1
KACG150-10	10	45	35.9	50	41.5
KACG150-15	15	40	39.6	50	42.4
KACG150-20	20	35	43.5	50	43.5
KACG150-25	25	30	47.7	50	45.1
KACG150-30	30	25	52.3	50	47.2
KACG150-35	35	20	57.3	50	50.0
KACG150-40	40	15	63.0	50	53.4
KACG150-45	45	10	69.6	50	57.9
KACG150-50	50	5	77.4	50	63.7
KACG150-55	55	0	87.1	50	71.4
KACG150-60	60	-5	99.5	50	81.9
KACG150-65	65	-10	116.5	50	96.9

**Übersicht Schieberkraft / Rückzugskraft
Table of Cam Force**

Typ / Type	α	Federkraft (N/kgf) / Spring Force (N / kgf)		Arbeitskraft (kN / tonF) / (KN / tonF) Work Force	
		Anfangskraft / Initial Load	Endkraft / Final Load	1 Mio. Hübe / strokes Standard-Arbeitskraft / Standard Working Force	300.000 Hübe / strokes Zulässige Arbeitskraft / Allowable Working Force
Schraubendruckfeder / Coil Spring	00° ~ 65°	862.4 / 87.9	7022.4 / 715.9	147.0 / 15.0	294.0 / 30.0

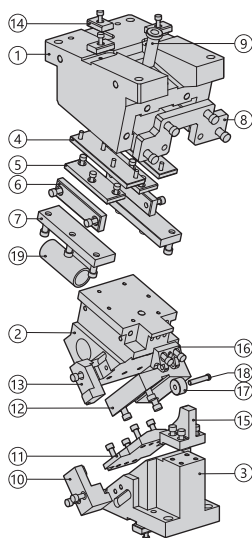

Nr. / No.	Beschreibung / Description	Anzahl / Qty	Material und Anmerkung / Material and Remark
①	Aufnahme / Cam Holder	1	HT300
②	Schieber / Cam Slider	1	HT300
③	Treiber / Cam Driver	1	HT300
④	Gleitplatte / Guide Block	1	Bronze+Festschmierstoff / graphite plugs
⑤	Gleitplatte / Guide Block	2	42CrMo
⑥	Führungsleiste / Side Platen	2	42CrMo
⑦	Gleitplatte / Guide Block	2	Bronze+Festschmierstoff / graphite plugs
⑧	Federplatte / Spring Plate	1	St45
⑨	Sicherheitsbolzen / Sleeve	1	St45
⑩	Zwangsrückführung / Hook	1	St45
⑪	V-Prisma / V Cam Slide Guide	1	Bronze+Festschmierstoff / graphite plugs
⑫	V-Prisma / V Cam Slide Guide	1	42CrMo
⑬	Zwangsrückführung / Positive Return Follower	1	St45
⑭	Passfeder / Key	6	St45
⑮	Beschleuniger / Guide	1	St45
⑯	Rollenblock / Roller Installing Seat	1	St45
⑰	Rolle / Roller	1	St45
⑱	Rollenachse / Rotation Axis	1	20Cr
⑲	Feder / Spring	1	TJH50-203

Options-Code / Option Code	Beschreibung / Envelope
K	metrische T-Passfeder an Aufnahme und Treiber montiert / Metric dedicated key is attached for both cam holder and driver.
KA	Zoll-Passfeder an Aufnahme und Treiber montiert / Inch dedicated key is attached for both cam holder and driver.
N13	Stiftlöcher in Aufnahme und Treiber auf $\Phi 13$ verändert / The dowel holes for the cam holder and cam driver are chanee to $\Phi 13$

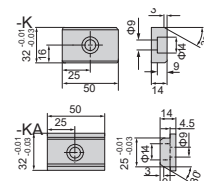
 Ausführung Passfeder /
Key specification

Bestellnummer / Order Number

☎	Bestellnr. / Catalog No.	-	(W)	-	(α)
---	--------------------------	---	-----	---	--------------

KACG - 150 - 30
KACG - 150 - 30 - K

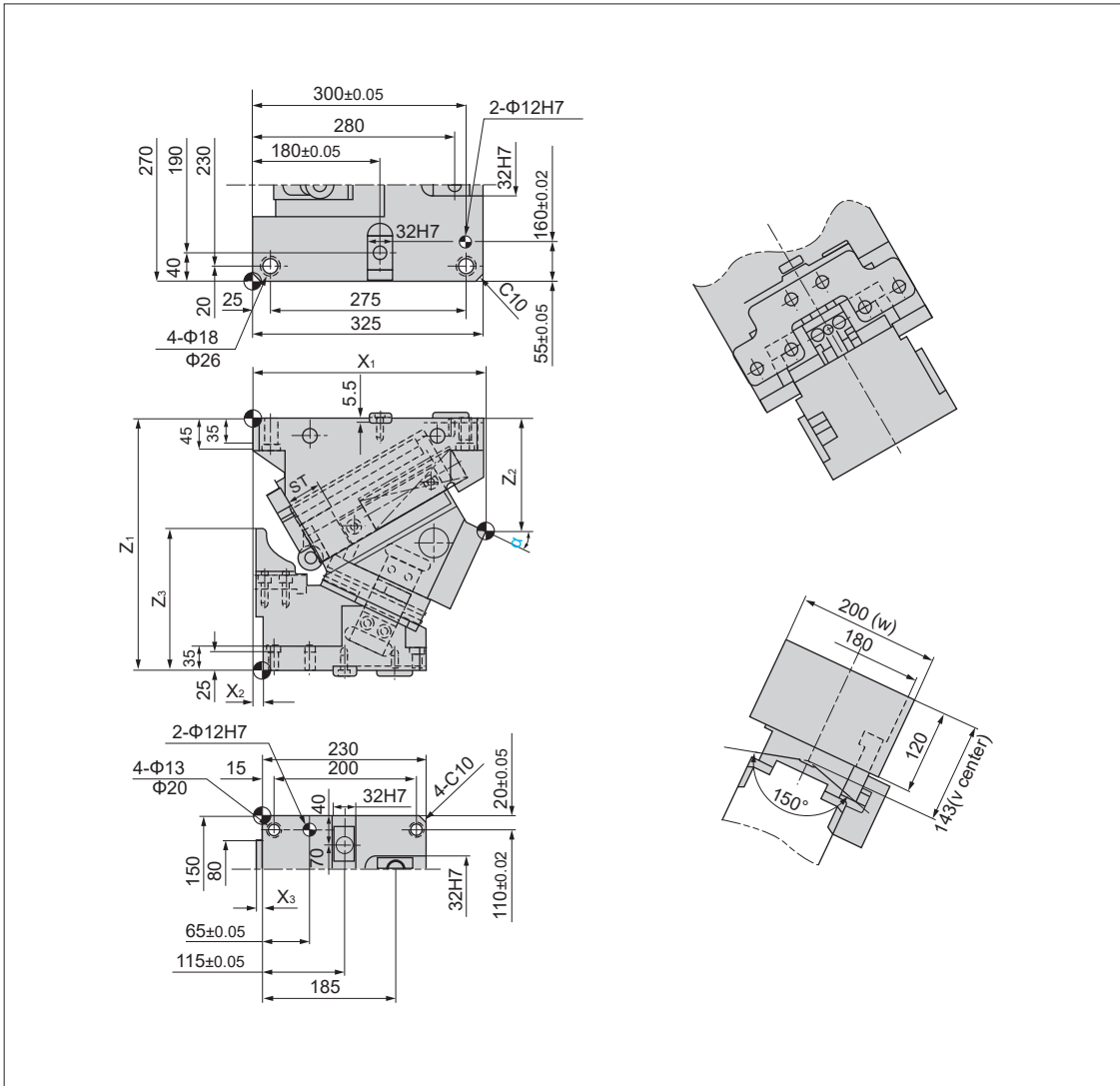

KACG200

**Tabelle Schieber
Table of Cam Structure**

Bestellnr. / Catalog No.	W	X ₁	X ₂	X ₃	Z ₁	Z ₂	Z ₃	Gewicht (kg) / Weight (kg)
KACG200-00	200	325.00	80	25	355	130.00	105	129.7
KACG200-05	200	319.70	60	25	355	133.26	125	126.6
KACG200-10	200	319.06	45	25	355	137.79	145	124.8
KACG200-15	200	322.98	35	20	355	143.56	160	127.4
KACG200-20	200	326.33	25	15	355	150.51	180	123.2
KACG200-25	200	329.03	15	10	355	158.61	200	123.0
KACG200-30	200	325.98	0	0	355	167.78	215	121.7
KACG200-35	200	322.08	-15	0	355	192.95	220	125.3
KACG200-40	200	312.26	-35	0	355	204.06	240	126.8
KACG200-45	200	306.42	-50	0	355	216.01	260	127.9
KACG200-50	200	294.51	-70	0	355	228.71	280	129.8
KACG200-55	200	281.46	-90	0	355	242.07	295	132.6
KACG200-60	200	272.22	-105	0	355	255.98	315	135.1
KACG200-65	200	261.75	-120	0	355	270.34	340	138.9

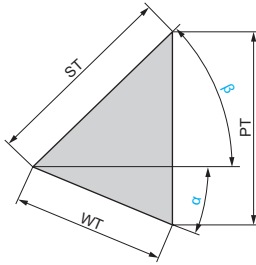



Bestellnr. / Catalog No.	α	β	WT	ST	PT
KACG200-00	0	55	28.6	50	40.9
KACG200-05	5	50	32.2	50	41.1
KACG200-10	10	45	35.9	50	41.5
KACG200-15	15	40	39.6	50	42.4
KACG200-20	20	35	43.5	50	43.5
KACG200-25	25	30	47.7	50	45.1
KACG200-30	30	25	52.3	50	47.2
KACG200-35	35	20	57.3	50	50.0
KACG200-40	40	15	63.0	50	53.4
KACG200-45	45	10	69.6	50	57.9
KACG200-50	50	5	77.4	50	63.7
KACG200-55	55	0	87.1	50	71.4
KACG200-60	60	-5	99.5	50	81.9
KACG200-65	65	-10	116.5	50	96.9

**Übersicht Schieberkraft / Rückzugskraft
Table of Cam Force**

Typ / Type	α	Federkraft (N/kgf) / Spring Force (N / kgf)		Arbeitskraft (kN / tonF) / (KN / tonF) Work Force	
		Anfangskraft / Initial Load	Endkraft / Final Load	1 Mio. Hübe / strokes Standard-Arbeitskraft / Standard Working Force	300.000 Hübe / strokes Zulässige Arbeitskraft / Allowable Working Force
Schraubendruckfeder / Coil Spring	00° ~ 65°	862.4 / 87.9	7022.4 / 715.9	147.0 / 15.0	294.0 / 30.0

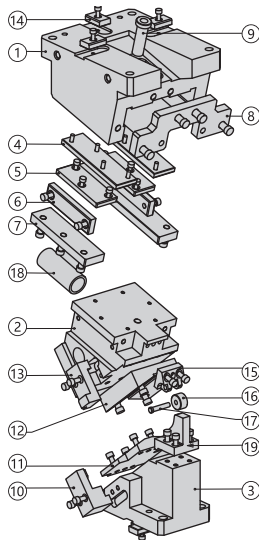

Nr. / No.	Beschreibung / Description	Anzahl / Qty	Material und Anmerkung / Material and Remark
①	Aufnahme / Cam Holder	1	HT300
②	Schieber / Cam Slider	1	HT300
③	Treiber / Cam Driver	1	HT300
④	Gleitplatte / Guide Block	1	Bronze+Festschmierstoff / graphite plugs
⑤	Gleitplatte / Guide Block	2	42CrMo
⑥	Führungsleiste / Side Platen	2	42CrMo
⑦	Gleitplatte / Guide Block	2	Bronze+Festschmierstoff / graphite plugs
⑧	Federplatte / Spring Plate	1	St45
⑨	Sicherheitsbolzen / Sleeve	1	St45
⑩	Zwangsrückführung / Hook	1	St45
⑪	V-Prisma / V Cam Slide Guide	1	42CrMo
⑫	V-Prisma / V Cam Slide Guide	1	Bronze+Festschmierstoff / graphite plugs
⑬	Zwangsrückführung / Positive Return Follower	1	Bronze+Festschmierstoff / graphite plugs
⑭	Passfeder / Key	6	St45
⑮	Rollenblock / Roller Installing Seat	1	St45
⑯	Rolle / Roller	1	St45
⑰	Rollenachse / Rotation Axis	1	T10A
⑱	Feder / Spring	1	TJH50-203
⑲	Beschleuniger / Guide	1	St45

Options-Code / Option Code	Beschreibung / Envelope
K	metrische T-Passfeder an Aufnahme und Treiber montiert / Metric dedicated key is attached for both cam holder and driver.
KA	Zoll-Passfeder an Aufnahme und Treiber montiert / Inch dedicated key is attached for both cam holder and driver.
N13	Stiftlöcher in Aufnahme und Treiber auf $\Phi 13$ verändert / The dowel holes for the cam holder and cam driver are change to $\Phi 13$

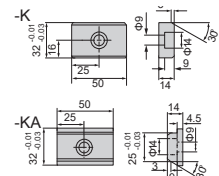
 Ausführung Passfeder /
Key specification

Bestellnummer / Order Number

☎	Bestellnr. / Catalog No.	-	(W)	-	(α)
	KACG	-	200	-	30
	KACG	-	200	-	30 - K

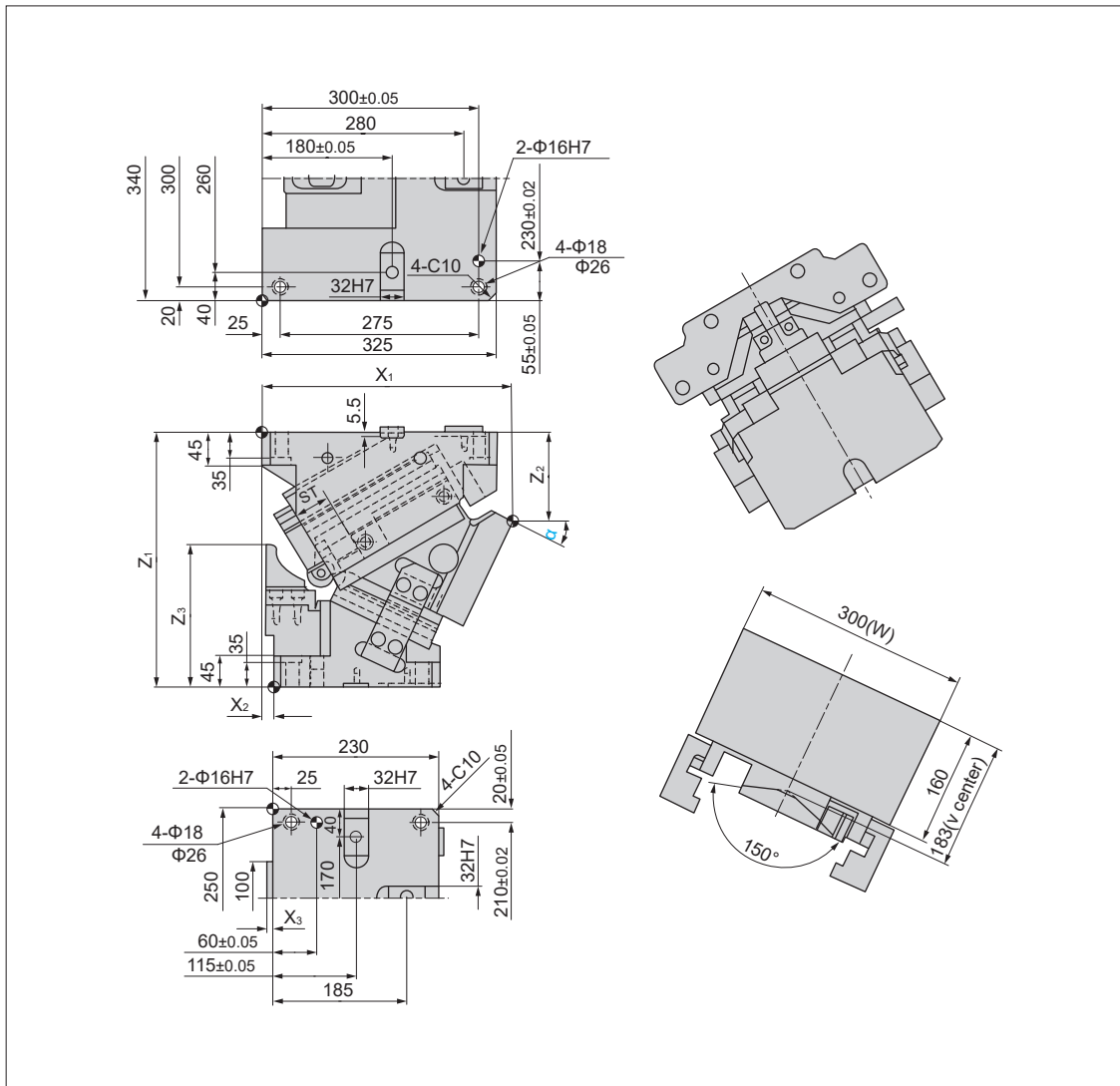

KACG300

**Tabelle Schieber
Table of Cam Structure**

Bestellnr. / Catalog No.	W	X ₁	X ₂	X ₃	Z ₁	Z ₂	Z ₃	Gewicht (kg) / Weight (kg)
KACG300-00	300	325.00	80	25	355	90.00	105.0	184.5
KACG300-05	300	323.19	60	25	355	93.41	125.0	181.0
KACG300-10	300	326.01	45	25	355	98.40	145.0	178.7
KACG300-15	300	333.33	35	20	355	104.92	159.5	177.3
KACG300-20	300	340.02	25	15	355	112.93	180.0	176.0
KACG300-25	300	345.94	15	10	355	122.35	200.0	174.9
KACG300-30	300	345.98	0	0	355	133.13	215.0	173.8
KACG300-35	300	345.03	-15	0	355	160.19	220.0	178.7
KACG300-40	300	337.97	-35	0	355	173.41	240.0	181.6
KACG300-45	300	334.71	-50	0	355	187.72	260.0	184.5
KACG300-50	300	325.15	-70	0	355	203.00	280.0	188.1
KACG300-55	300	314.23	-90	0	355	219.12	295.0	193.4
KACG300-60	300	306.87	-105	0	355	235.98	315.0	197.6
KACG300-65	300	298.00	-120	0	355	253.44	340.0	202.9

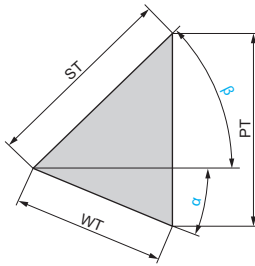



Bestellnr. / Catalog No.	α	β	WT	ST	PT
KACG300-00	0	55	28.6	50	40.9
KACG300-05	5	50	32.2	50	41.1
KACG300-10	10	45	35.9	50	41.5
KACG300-15	15	40	39.6	50	42.4
KACG300-20	20	35	43.5	50	43.5
KACG300-25	25	30	47.7	50	45.1
KACG300-30	30	25	52.3	50	47.2
KACG300-35	35	20	57.3	50	50.0
KACG300-40	40	15	63.0	50	53.4
KACG300-45	45	10	69.6	50	57.9
KACG300-50	50	5	77.4	50	63.7
KACG300-55	55	0	87.1	50	71.4
KACG300-60	60	-5	99.5	50	81.9
KACG300-65	65	-10	116.5	50	96.9

**Übersicht Schieberkraft / Rückzugskraft
Table of Cam Force**

Typ / Type	α	Federkraft (N/kgf) / Spring Force (N / kgf)		Arbeitskraft (kN / tonF) / (KN / tonF) Work Force	
		Anfangskraft / Initial Load	Endkraft / Final Load	1 Mio. Hübe / strokes Standard-Arbeitskraft / Standard Working Force	300.000 Hübe / strokes Zulässige Arbeitskraft / Allowable Working Force
Schraubendruckfeder / Coil Spring	00° ~ 65°	1724.8 / 175.8	14044.8 / 1431.8	294.0 / 30.0	588.0 / 60.0

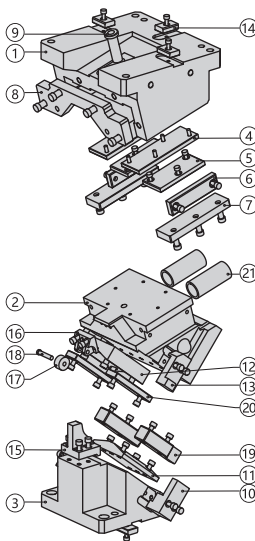

Nr. / No.	Beschreibung / Description	Anzahl / Qty	Material und Anmerkung / Material and Remark
①	Aufnahme / Cam Holder	1	HT300
②	Schieber / Cam Slider	1	HT300
③	Treiber / Cam Driver	1	HT300
④	Gleitplatte / Guide Block	1	Bronze+Festschmierstoff / graphite plugs
⑤	Gleitplatte / Guide Block	2	42CrMo
⑥	Führungsleiste / Side Platen	2	42CrMo
⑦	Gleitplatte / Guide Block	2	Bronze+Festschmierstoff / graphite plugs
⑧	Federplatte / Spring Plate	1	St45
⑨	Sicherheitsbolzen / Sleeve	1	St45
⑩	Zwangsrückführung / Hook	1	St45
⑪	V-Prisma / V Cam Slide Guide	1	42CrMo
⑫	V-Prisma / V Cam Slide Guide	1	Bronze+Festschmierstoff / graphite plugs
⑬	Zwangsrückführung / Positive Return Follower	1	Bronze+Festschmierstoff / graphite plugs
⑭	Passfeder / Key	6	St45
⑮	Beschleuniger / Guide	1	St45
⑯	Rollenblock / Roller Installing Seat	1	St45
⑰	Rolle / Roller	1	St45
⑱	Rollenachse / Rotation Axis	1	20Cr
⑲	Gleitplatte / Guide Block	2	42CrMo
⑳	Gleitplatte / Guide Block	2	Bronze+Festschmierstoff / graphite plugs
㉑	Feder / Spring	2	TJH50-203

Options-Code / Option Code	Beschreibung / Envelope
K	metrische T-Passfeder an Aufnahme und Treiber montiert / Metric dedicated key is attached for both cam holder and driver.
KA	Zoll-Passfeder an Aufnahme und Treiber montiert / Inch dedicated key is attached for both cam holder and driver.

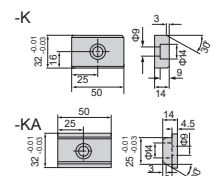
 Ausführung Passfeder /
Key specification

Bestellnummer / Order Number

☎	Bestellnr. / Catalog No.	-	(W)	-	(α)
	KACG	-	300	-	30
	KACG	-	300	-	30 - K

