



KBDA52

Fertiges Stiftloch / Dowel Pin Hole Finished

KBD52

Vorbereitetes Stiftloch / Dowel Pin Prepared Hole

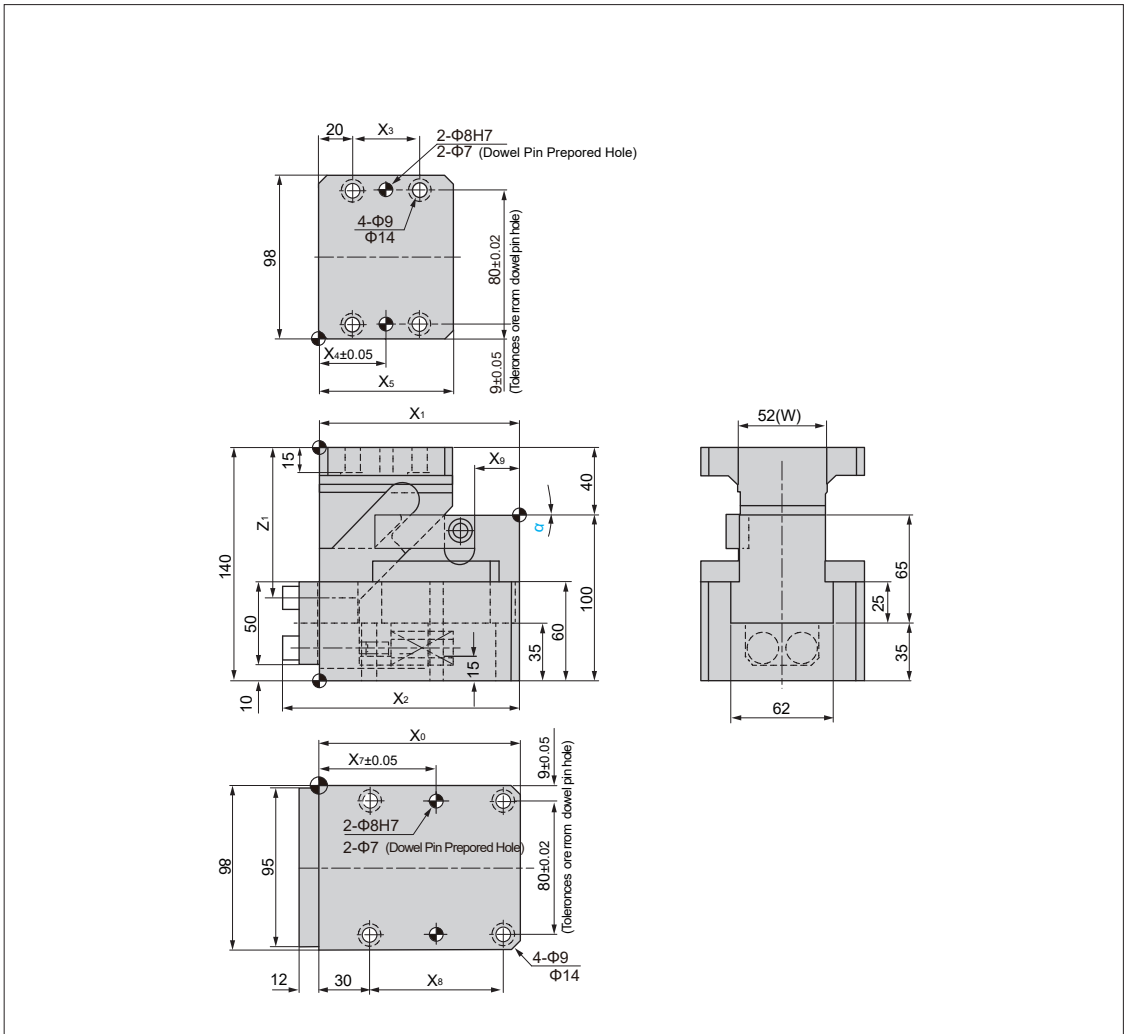

**Tabelle Schieber
Table of Cam Structure**

Bestellnr. / Catalog No.	W	X_1	X_2	X_3	X_4	X_5	X_6	X_7	X_8	X_9	Z_1	Gewicht (kg) / Weight (kg)
KBDA / KBD52-00-25	52	120	140	40	40	80	120	70	80	27	90	8.0
KBDA / KBD52-00-40	52	135	155	50	45	90	135	80	95	27	100	8.0
KBDA / KBD52-00-60	52	180	200	70	55	110	180	55	140	52	120	14.0



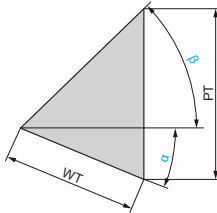

Bestellnr. / Catalog No.	α	β	WT	PT
KBDA / KBD52-00-25	0	45	25	25
KBDA / KBD52-00-40	0	45	40	40
KBDA / KBD52-00-60	0	45	60	60

**Übersicht Schieberkraft / Rückzugskraft
Table of Cam Force**

Typ / Type	α -WT	Modell / Model	Federkraft (N/kgf) / Spring Force (N / kgf)		Arbeitskraft (kN / tonF) / (kN / tonF) Work Force	
			Anfangskraft / Initial Load	Endkraft / Final Load	1 Mio. Hübe / strokes Standard-Arbeitskraft / Standard Working Force	300.000 Hübe / strokes Zulässige Arbeitskraft / Allowable Working Force
Schraubendruckfeder / Coil Spring	00° - 25	TF20-70	144.0 / 14.7	594.0 / 60.7	14.7/1.5	29.4/3.0
	00° - 40	TF20-100	100.8 / 10.2	604.8 / 61.4		
	00° - 60	TF20-150	109.2 / 11.2	613.2 / 62.8		

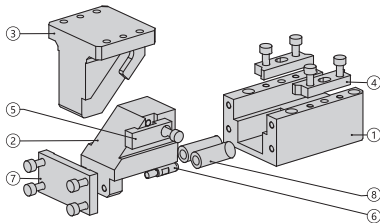

Nr. / No.	Beschreibung / Description	Anzahl / Qty	Material und Anmerkung / Material and Remark
①	Aufnahme / Cam Holder	1	HT300
②	Schieber / Cam Slider	1	HT300+Festschmierstoff / graphite plugs
③	Treiber / Cam Driver	1	HT300+Festschmierstoff / graphite plugs
④	Platte / Slide Plate	2	42CrMo+Festschmierstoff / graphite plugs
⑤	Zwangsrückführung / Position Return Follower	1	St45
⑥	Federführungsbolzen / Spring Guide Pin	2	St45
⑦	Stoppblock / Baffle	1	St45
⑧	Feder / Spring	2	Typ / Type

Bestellnummer / Order Number

	Bestellnr. / Catalog No.	-	(W)	-	(α)	-	WT
	KDMD	-	52	-	00	-	25



KBDA65

Fertiges Stiftloch / Dowel Pin Hole Finished

KBD65

Vorbereitetes Stiftloch / Dowel Pin Prepared Hole

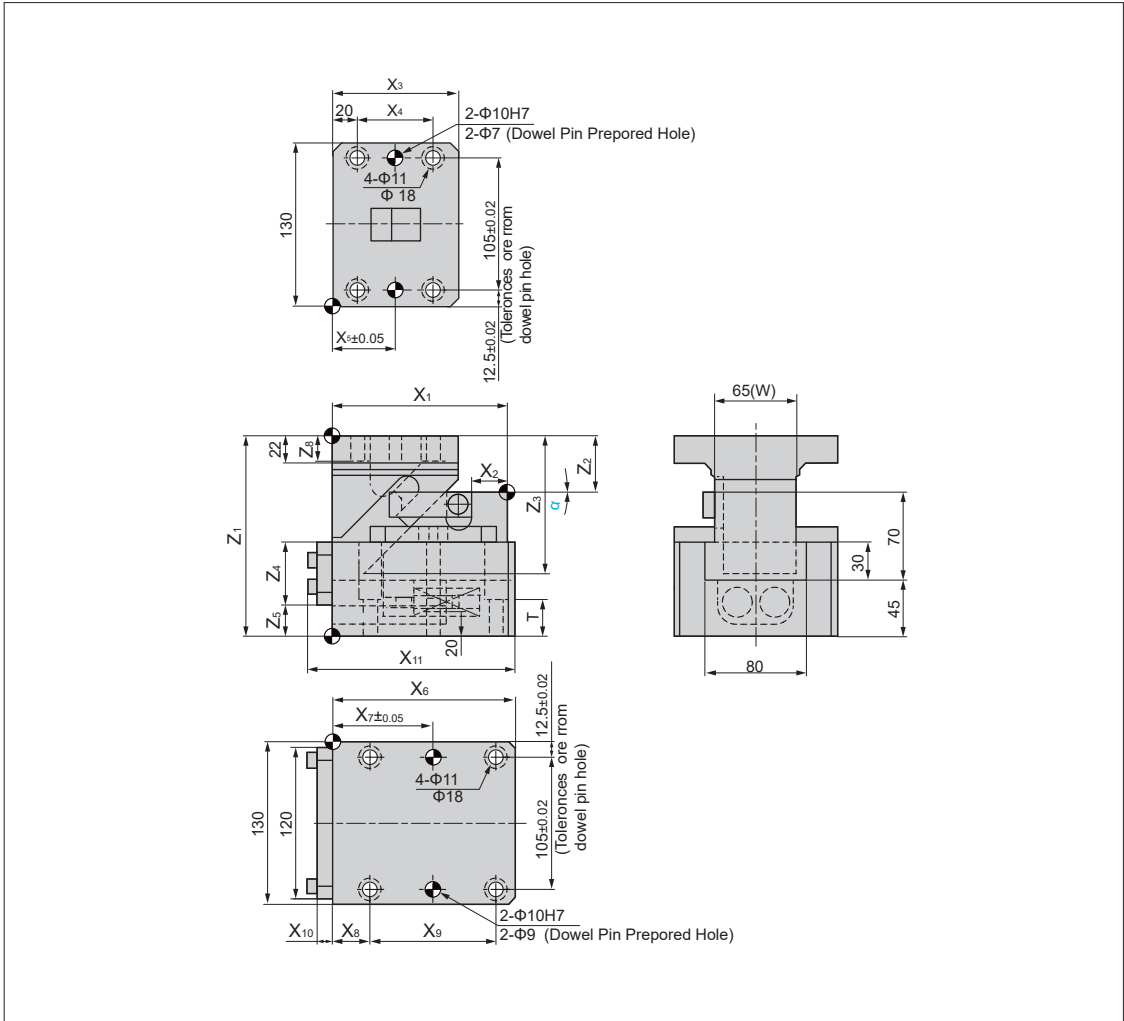
**Tabelle Schieber
Table of Cam Structure**

Bestellnr. / Catalog No.	W	X_1	X_2	X_3	X_4	X_5	X_6	X_7	X_8	X_9	X_{10}	X_{11}	Z_1	Z_2	Z_3	Z_4	Z_5	Z_6	Gewicht (kg) / Weight (kg)	T
KBDA / KBD65-00-40	65	140.00	30	100	60	50	145	80	30	100	12	167	160	45.00	110	50	25	20	20.0	30
KBDA / KBD65-00-60	65	190.00	62	110	70	55	180	105	40	125	12	212	160	45.00	130	50	25	20	21.0	30
KBDA / KBD65-05-45	65	150.55	26.1	100	60	50	145	80	30	100	15	175.55	160	47.90	125	100	12.5	18	19.0	40
KBDA / KBD65-05-70	65	195.38	51.9	100	60	50	180	65	40	125	15	220.38	170	46.83	145	100	25	18	22.2	40
KBDA / KBD65-10-45	65	154.95	26.1	100	60	50	145	79	30	100	15	179.95	160	51.24	115	100	20	18	16.2	40
KBDA / KBD65-10-70	65	199.27	40	100	60	50	180	65	40	125	15	224.27	170	59.06	145	100	25	18	20.5	40
KBDA / KBD65-15-45	65	158.18	26.1	100	60	50	145	80	30	100	15	183.18	170	64.91	115	100	25	18	22.3	40
KBDA / KBD65-15-70	65	201.64	51.9	110	70	55	180	65	40	125	15	226.64	170	66.56	125	100	40	18	22.3	40
KBDA / KBD65-20-45	65	160.2	26.1	100	60	50	145	80	30	100	15	185.2	170	68.81	105	100	30	18	22.3	40
KBDA / KBD65-20-70	65	202.48	51.9	110	70	55	180	65	40	125	15	227.48	170	74.21	120	100	40	18	21.0	40



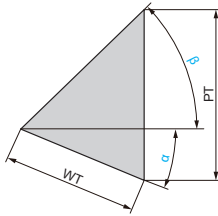

Bestellnr. / Catalog No.	α	β	WT	PT
KBDA / KBD65-00-40	0	45	40	40
KBDA / KBD65-00-60	0	45	60	60
KBDA / KBD65-05-45	5	55	45	67.9
KBDA / KBD65-05-70	5	55	70	105.7
KBDA / KBD65-10-45	10	50	45	60.6
KBDA / KBD65-10-70	10	50	70	94.3
KBDA / KBD65-15-45	15	45	45	55.1
KBDA / KBD65-15-70	15	45	70	85.7
KBDA / KBD65-20-45	20	40	45	50.8
KBDA / KBD65-20-70	20	40	70	79.1

**Übersicht Schieberkraft / Rückzugskraft
Table of Cam Force**

Typ / Type	α -WT	Modell / Model	Federkraft (N/kgf) / Spring Force (N / kgf)		Arbeitskraft (kN / tonF) / (kN / tonF) Work Force	
			Anfangskraft / Initial Load	Endkraft / Final Load	1 Mio. Hübe / strokes Standard-Arbeitskraft / Standard Working Force	300.000 Hübe / strokes Zulässige Arbeitskraft / Allowable Working Force
Schraubendruckfeder / Coil Spring	00° - 40	TF22-100	124.8 / 12.8	748.8 / 76.8	19.6 / 2.0	39.2 / 4.0
	00° - 60	TF22-150	135.2 / 13.8	759.2 / 77.4		
	05° - 45	TF22-125	176.4 / 17.9	743.4 / 75.5		
	05° - 70	TF22-175	190.4 / 19.4	974.4 / 99.2		
	10° - 45	TF22-125	176.4 / 17.9	743.4 / 75.5		
	10° - 70	TF22-175	190.4 / 19.4	974.4 / 99.2		
	15° - 45	TF22-125	176.4 / 17.9	743.4 / 75.5		
	15° - 70	TF22-175	190.4 / 19.4	974.4 / 99.2		
	20° - 45	TF22-125	176.4 / 17.9	743.4 / 75.5		
20° - 70	TF22-175	190.4 / 19.4	974.4 / 99.2			

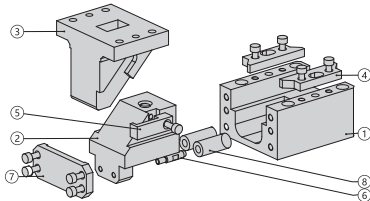

Nr. / No.	Beschreibung / Description	Anzahl / Qty	Material und Anmerkung / Material and Remark
①	Aufnahme / Cam Holder	1	HT300
②	Schieber / Cam Slider	1	HT300+Festschmierstoff / graphite plugs
③	Treiber / Cam Driver	1	HT300+Festschmierstoff / graphite plugs
④	Platte / Slide Plate	2	42CrMo+Festschmierstoff / graphite plugs
⑤	Zwangsrückführung / Position Return Follower	1	St45
⑥	Federführungsbolzen / Spring Guide Pin	2	St45
⑦	Stoppblock / Baffle	1	St45
⑧	Feder / Spring	2	Typ / Type

Bestellnummer / Order Number

	Bestellnr. / Catalog No.	-	(W)	-	(α)	-	WT
	KDMD	-	65	-	00	-	40



KBDA100

Fertiges Stifflloch / Dowel Pin Hole Finished

KBD100

Vorbereitetes Stifflloch / Dowel Pin Prepared Hole

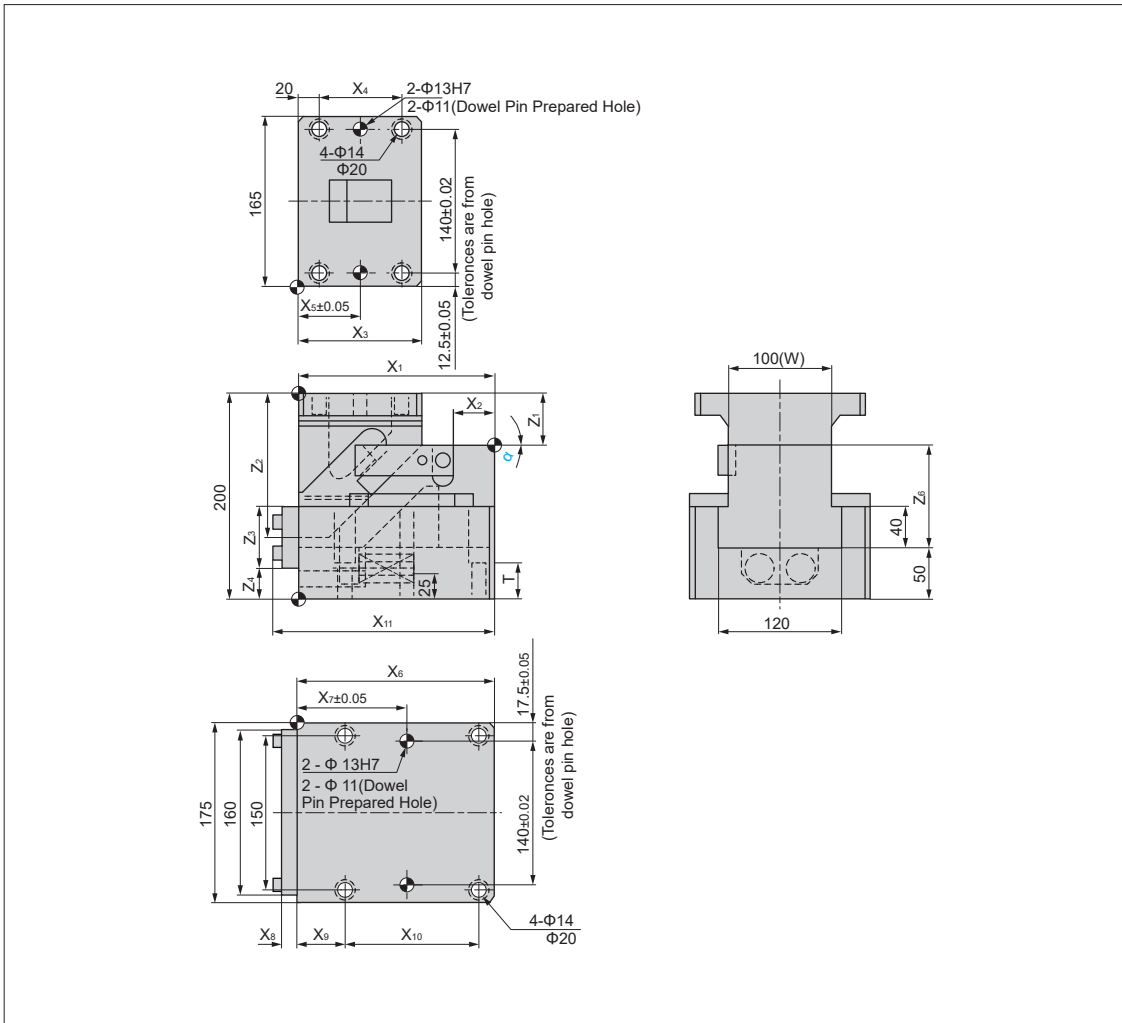
**Tabelle Schieber
Table of Cam Structure**

Bestellnr. / Catalog No.	W	X ₁	X ₂	X ₃	X ₄	X ₅	X ₆	X ₇	X ₈	X ₉	X ₁₀	X ₁₁	Z ₁	Z ₂	Z ₃	Z ₄	Z ₅	Gewicht (kg) / Weight (kg)	T
KBDA / KBD100-00-40	100	190.00	40	120	80	60	190	105	16	45	130	218	50.00	140	60	30.0	100	37.0	35
KBDA / KBD100-00-60	100	210.00	40	140	100	70	190	108	16	45	130	238	50.00	160	60	30.0	100	28.0	35
KBDA / KBD100-00-80	100	250.00	70	150	110	75	220	135	15	45	160	277	50.00	170	115	10.0	100	44.0	35
KBDA / KBD100-05-45	100	172.22	28.8	100	60	50	160	90	15	40	105	199.22	54.72	140	115	27.5	90	33.0	35
KBDA / KBD100-05-70	100	207.08	44.6	120	80	60	190	70	15	45	130	234.08	52.77	160	115	30.0	90	38.0	40
KBDA / KBD100-10-45	100	178.12	28.8	100	60	50	160	90	15	40	105	205.12	65.02	140	115	30.0	90	33.0	35
KBDA / KBD100-10-70	100	212.59	44.6	120	80	60	190	70	15	45	130	239.59	66.1	160	115	30.0	90	38.0	40
KBDA / KBD100-15-45	100	182.67	28.8	110	70	55	160	90	15	40	105	209.67	70.77	125	115	32.5	90	33.0	40
KBDA / KBD100-15-70	100	216.48	44.6	130	90	65	190	70	15	45	130	243.48	69.83	130	115	35.0	90	38.0	40
KBDA / KBD100-20-45	100	185.83	28.8	110	70	55	160	90	15	40	105	212.83	81.86	120	115	35.0	90	32.0	40
KBDA / KBD100-20-70	100	218.72	44.6	130	90	65	190	70	15	45	130	245.72	78.83	130	115	45.0	90	39.0	40



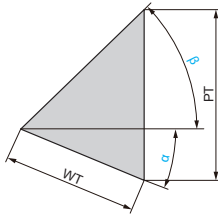

Bestellnr. / Catalog No.	α	β	WT	PT
KBDA / KBD100-00-40	0	45	40	40
KBDA / KBD100-00-60	0	45	60	60
KBDA / KBD100-00-80	0	45	80	80
KBDA / KBD100-05-45	5	55	45	67.9
KBDA / KBD100-05-70	5	55	70	105.7
KBDA / KBD100-10-45	10	50	45	60.6
KBDA / KBD100-10-70	10	50	70	94.3
KBDA / KBD100-15-45	15	45	45	55.1
KBDA / KBD100-15-70	15	45	70	85.7
KBDA / KBD100-20-45	20	40	45	50.8
KBDA / KBD100-20-70	20	40	70	79.1

**Übersicht Schieberkraft / Rückzugskraft
Table of Cam Force**

Typ / Type	α -WT	Modell / Model	Federkraft (N/kgf) / Spring Force (N / kgf)		Arbeitskraft (kN / tonF) / (kN / tonF) Work Force	
			Anfangskraft / Initial Load	Endkraft / Final Load	1 Mio. Hübe / strokes Standard-Arbeitskraft / Standard Working Force	300.000 Hübe / strokes Zulässige Arbeitskraft / Allowable Working Force
Schraubendruckfeder / Coil Spring	00° - 40	TF27-100	188.8 / 19.2	1132.8 / 115.2	29.4 / 3.0	58.8 / 6.0
	00° - 60	TF27-150	202.8 / 20.8	1138.8 / 116.8		
	00° - 80	TF30-200	170.4 / 17.3	1306.4 / 132.5		
	05° - 45	TF27-125	263.2 / 26.9	1109.2 / 113.3	39.2 / 4.0	78.4 / 8.0
	05° - 70	TF27-175	197.2 / 20.0	1149.2 / 116.6		
	10° - 45	TF27-125	263.2 / 26.9	1109.2 / 113.3		
	10° - 70	TF27-175	197.2 / 20.0	1149.2 / 116.6		
	15° - 45	TF27-125	263.2 / 26.9	1109.2 / 113.3		
	15° - 70	TF27-175	197.2 / 20.0	1149.2 / 116.6		
	20° - 45	TF27-125	263.2 / 26.9	1109.2 / 113.3		
20° - 70	TF27-125	197.2 / 20.01	1149.2 / 116.6			

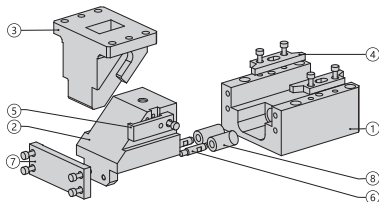

Nr. / No.	Beschreibung / Description	Anzahl / Qty	Material und Anmerkung / Material and Remark
①	Aufnahme / Cam Holder	1	HT300
②	Schieber / Cam Slider	1	HT300+Festschmierstoff / graphite plugs
③	Treiber / Cam Driver	1	HT300+Festschmierstoff / graphite plugs
④	Platte / Slide Plate	2	42CrMo+Festschmierstoff / graphite plugs
⑤	Zwangsrückführung / Position Return Follower	1	St45
⑥	Federführungsbolzen / Spring Guide Pin	2	St45
⑦	Stoppblock / Baffle	1	St45
⑧	Feder / Spring	2	Typ / Type

Bestellnummer / Order Number

	Bestellnr. / Catalog No.	(W)	(α)	WT
	KBDA	- 100	- 00	- 40



KBDA150

Fertiges Stiftdloch / Dowel Pin Hole Finished

KBD150

Vorbereitetes Stiftdloch / Dowel Pin Prepared Hole

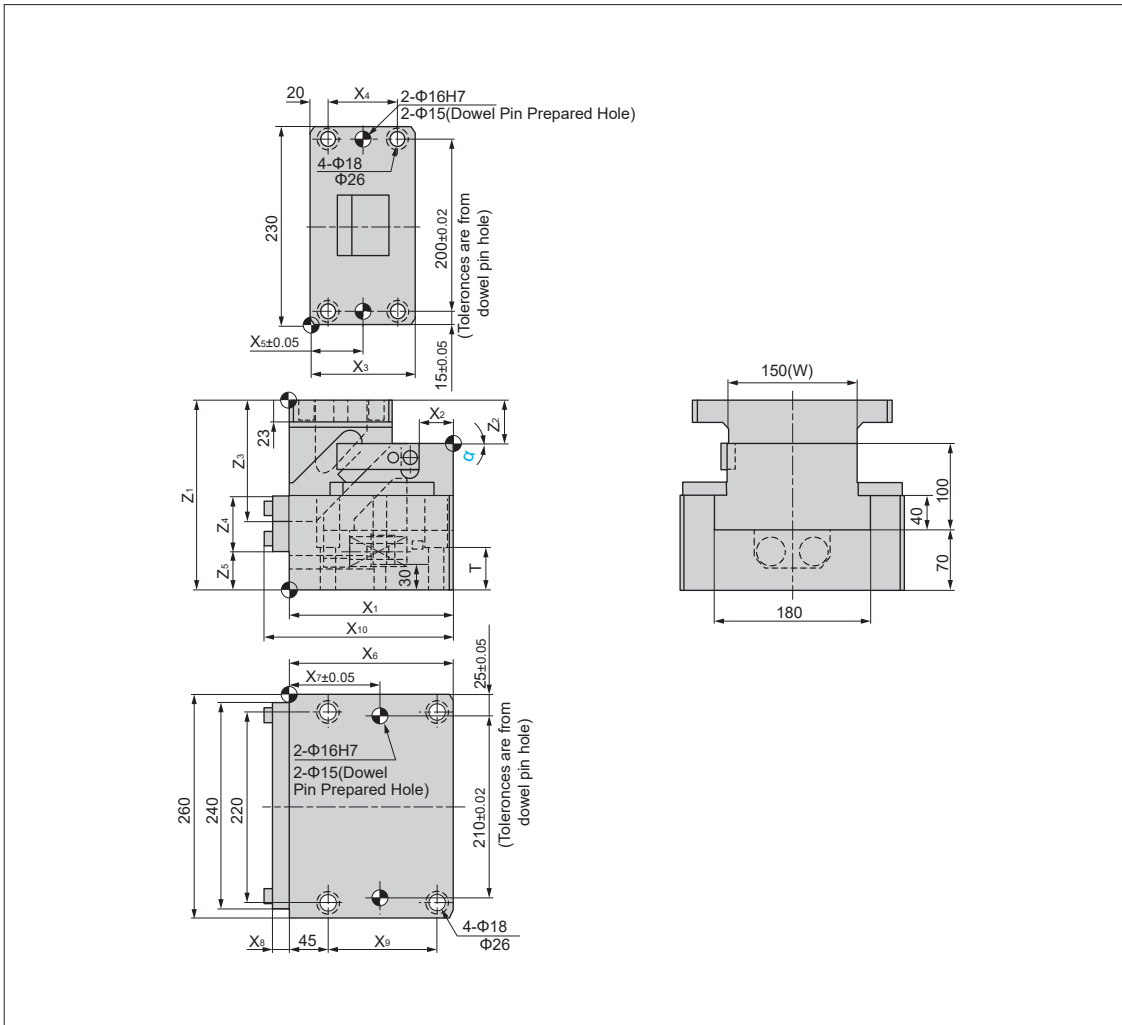
**Tabelle Schieber
Table of Cam Structure**

Bestellnr. / Catalog No.	W	X ₁	X ₂	X ₃	X ₄	X ₅	X ₆	X ₇	X ₈	X ₉	X ₁₀	Z ₁	Z ₂	Z ₃	Z ₄	Z ₅	Gewicht (kg) / Weight (kg)	T
KBDA / KBD150-00-40	150	190.00	40.0	120	80	60	190	105	19	125	225	220	50.00	140	65	45	63.0	50
KBDA / KBD150-00-60	150	210.00	40.0	140	100	70	200	110	19	135	245	220	50.00	160	65	45	69.0	50
KBDA / KBD150-05-45	150	193.01	36.1	110	70	55	190	105	20	125	229.01	220	61.50	145	125	30	62.0	35
KBDA / KBD150-05-70	150	217.92	36.1	130	90	65	200	120	20	135	253.92	220	53.68	170	125	40	73.0	45
KBDA / KBD150-10-45	150	199.55	36.1	110	70	55	190	105	20	125	235.55	220	68.64	140	125	40	63.0	45
KBDA / KBD150-10-70	150	224.174	36.1	130	90	65	200	120	20	135	260.17	220	67.98	170	125	40	73.0	45
KBDA / KBD150-15-45	150	204.58	36.1	120	80	60	190	105	20	125	240.58	220	76.29	130	125	40	65.0	45
KBDA / KBD150-15-70	150	228.73	36.1	140	100	70	200	120	20	135	264.73	230	77.76	155	125	55	77.0	60
KBDA / KBD150-20-45	150	208.05	36.1	120	80	60	190	105	20	125	244.05	220	84.30	130	125	40	66.0	45
KBDA / KBD150-20-70	150	231.54	36.1	140	100	70	200	120	20	135	267.54	230	92.85	155	125	55	75.0	60



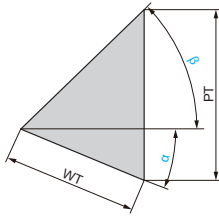

Bestellnr. / Catalog No.	α	β	WT	PT
KBDA / KBD150-00-40	0	45	40	40
KBDA / KBD150-00-60	0	45	60	60
KBDA / KBD150-05-45	5	55	45	67.9
KBDA / KBD150-05-70	5	55	70	105.7
KBDA / KBD150-10-45	10	50	45	60.6
KBDA / KBD150-10-70	10	50	70	94.3
KBDA / KBD150-15-45	15	45	45	55.1
KBDA / KBD150-15-70	15	45	70	85.7
KBDA / KBD150-20-45	20	40	45	50.8
KBDA / KBD150-20-70	20	40	70	79.1

**Übersicht Schieberkraft / Rückzugskraft
Table of Cam Force**

Typ / Type	α -WT	Modell / Model	Federkraft (N/kgf) / Spring Force (N / kgf)		Arbeitskraft (kN / tonF) / (KN / tonF) Work Force	
			Anfangskraft / Initial Load	Endkraft / Final Load	1 Mio. Hübe / strokes Standard-Arbeitskraft / Standard Working Force	300.000 Hübe / strokes Zulässige Arbeitskraft / Allowable Working Force
Schraubendruckfeder / Coil Spring	00° - 40	TF35-100	307.2 / 31.4	1843.2 / 188.2	58.8 / 6.0	88.2 / 9.0
	00° - 60	TF35-150	330.2 / 33.8	1854.2 / 189.8		
	05° - 45	TF35-125	428.4 / 43.7	1805.4 / 184.1	64.7 / 6.6	98.0 / 10.0
	05° - 70	TF35-175	308.0 / 31.4	1848.0 / 188.2		
	10° - 45	TF35-125	428.4 / 43.7	1805.4 / 184.1		
	10° - 70	TF35-175	308.0 / 31.4	1848.0 / 188.2		
	15° - 45	TF35-125	428.4 / 43.7	1805.4 / 184.1		
	15° - 70	TF35-175	308.0 / 31.4	1848.0 / 188.2		
	20° - 45	TF35-125	428.4 / 43.7	1805.4 / 184.1		
20° - 70	TF35-175	308.0 / 31.4	1848.0 / 188.2			

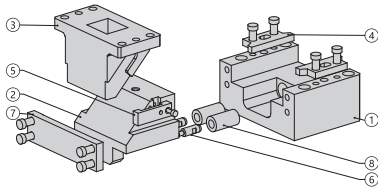

Nr. / No.	Beschreibung / Description	Anzahl / Qty	Material und Anmerkung / Material and Remark
①	Aufnahme / Cam Holder	1	HT300
②	Schieber / Cam Slider	1	HT300+Festschmierstoff / graphite plugs
③	Treiber / Cam Driver	1	HT300+Festschmierstoff / graphite plugs
④	Platte / Slide Plate	2	42CrMo+Festschmierstoff / graphite plugs
⑤	Zwangsrückführung / Position Return Follower	1	St45
⑥	Federführungsbolzen / Spring Guide Pin	2	St45
⑦	Stopblock / Baffle	1	St45
⑧	Feder / Spring	2	Typ / Type

Bestellnummer / Order Number

	Bestellnr. / Catalog No.	(W)	(α)	WT
	KBDA	150	00	40





KBDA200

Fertiges Stiftloch / Dowel Pin Hole Finished

KBD200

Vorbereitetes Stiftloch / Dowel Pin Prepared Hole



Tabelle Schieber
Table of Cam Structure

Bestellnr. / Catalog No.	W	X ₁	X ₂	X ₃	X ₄	X ₅	X ₆	X ₇	X ₈	Z ₁	Gewicht (kg) / Weight (kg)
KBDA / KBD200-00-40	200	200	130	90	65	200	110	135	236	160	82.0
KBDA / KBD200-00-60	200	220	150	110	75	210	120	145	256	180	84.0



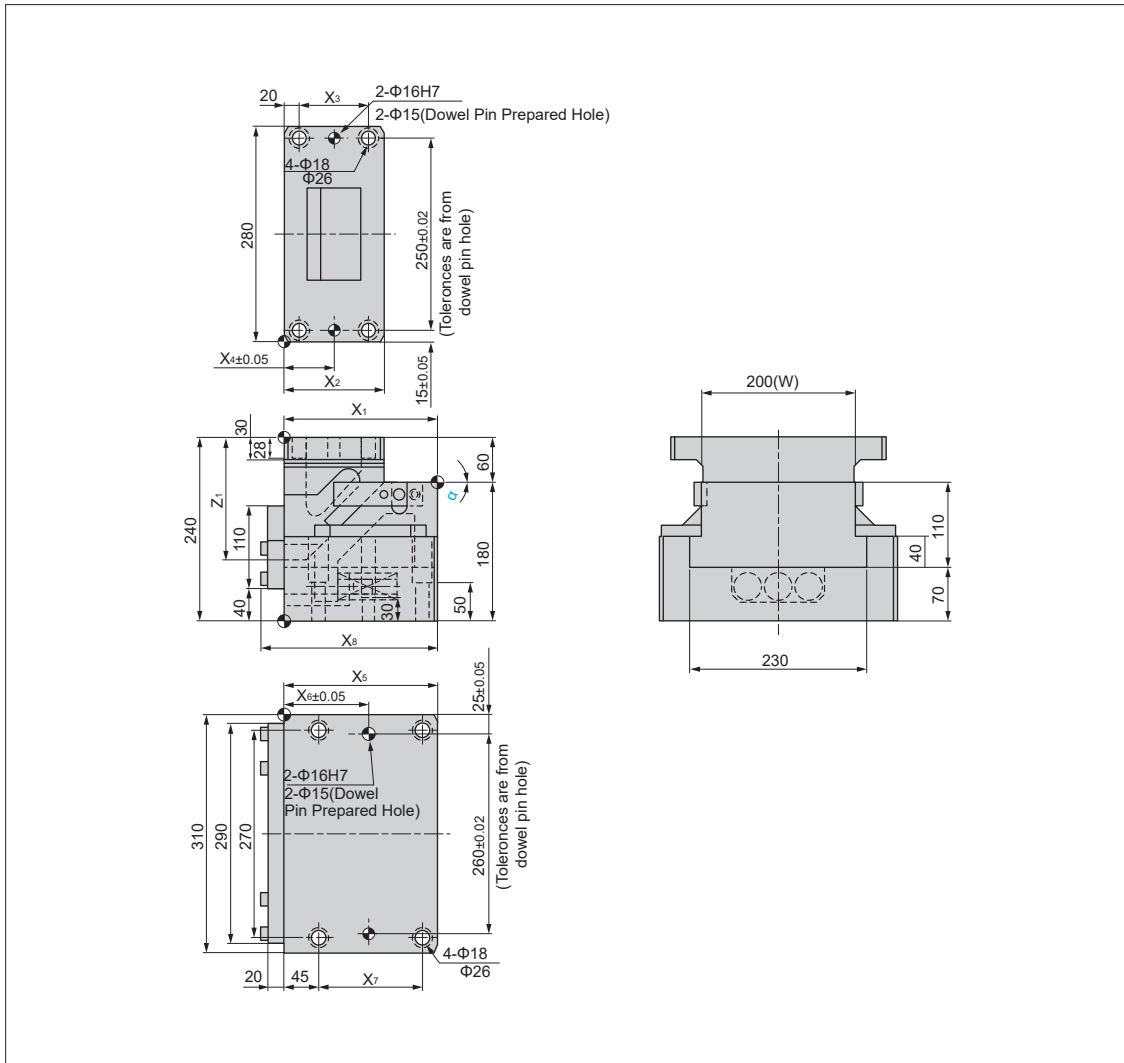
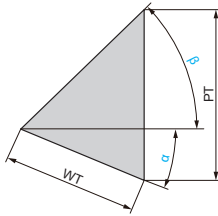

Bestellnr. / Catalog No.	α	β	WT	PT
KBDA / KBD200-00-40	0	45	40	40
KBDA / KBD200-00-60	0	45	60	60

Übersicht Schieberkraft / Rückzugskraft Table of Cam Force

Typ / Type	α -WT	Modell / Model	Federkraft (N/kgf) / Spring Force (N / kgf)		Arbeitskraft (kN / tonF) / (KN / tonF) Work Force	
			Anfangskraft / Initial Load	Endkraft / Final Load	1 Mio. Hübe / strokes Standard-Arbeitskraft / Standard Working Force	300.000 Hübe / strokes Zulässige Arbeitskraft / Allowable Working Force
Schraubendruckfeder / Coil Spring	00° - 40	TF35-100	460.8 / 47.0	2764.8 / 282.2	78.4 / 8.0	117.6 / 12.0
	00° - 60	TF35-150	495.3 / 50.7	2781.3 / 284.7		

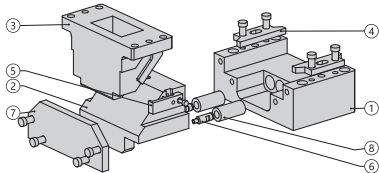

Nr. / No.	Beschreibung / Description	Anzahl / Qty	Material und Anmerkung / Material and Remark
①	Aufnahme / Cam Holder	1	HT300
②	Schieber / Cam Slider	1	HT300+Festschmierstoff / graphite plugs
③	Treiber / Cam Driver	1	HT300+Festschmierstoff / graphite plugs
④	Platte / Slide Plate	2	42CrMo+Festschmierstoff / graphite plugs
⑤	Zwangsrückführung / Position Return Follower	1	St45
⑥	Federführungsbolzen / Spring Guide Pin	2	St45
⑦	Stoppblock / Baffle	1	St45
⑧	Feder / Spring	2	Typ / Type

Bestellnummer / Order Number

	Bestellnr. / Catalog No.	(W)	(α)	WT
	KBDA	- 200 -	00 -	40



KBDA250

Fertiges Stifflloch / Dowel Pin Hole Finished

KBD250

Vorbereitetes Stifflloch / Dowel Pin Prepared Hole



Tabelle Schieber
Table of Cam Structure

Bestellnr. / Catalog No.	W	X_1	X_2	X_3	X_4	X_5	X_6	X_7	X_8	Z_1	Gewicht (kg) / Weight (kg)
KBDA / KBD250-00-40	250	210	135	140	100	70	200	105	246	170	106.0
KBDA / KBD250-00-60	250	230	155	160	120	80	220	125	266	190	127.0



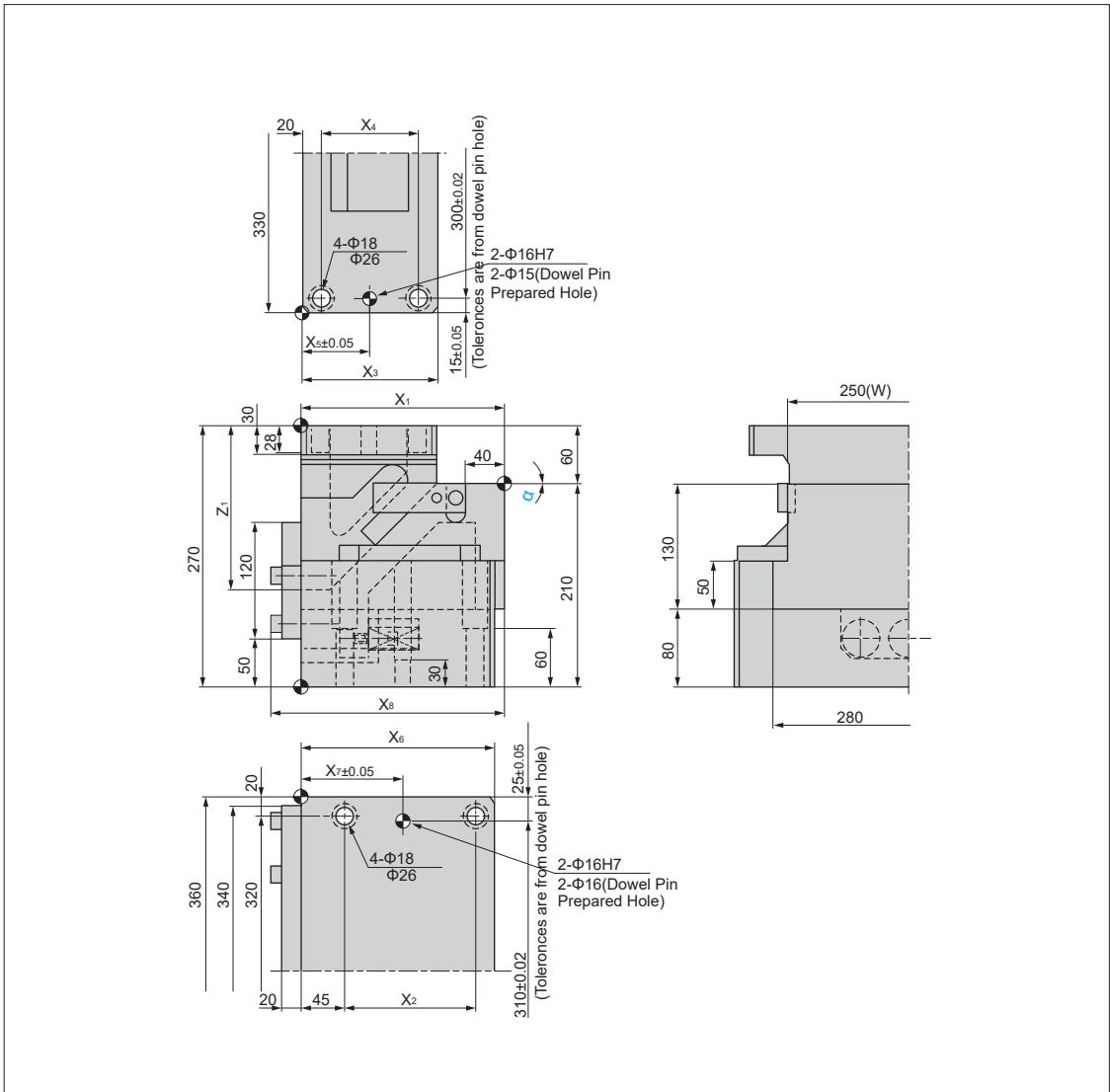
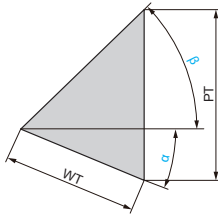

Bestellnr. / Catalog N.	α	β	WT	PT
KBDA / KBD250-00-40	0	45	40	40
KBDA / KBD250-00-60	0	45	60	60

**Übersicht Schieberkraft / Rückzugskraft
Table of Cam Force**

Typ / Type	α-WT	Modell / Model	Federkraft (N/kgf) / Spring Force (N / kgf)		Arbeitskraft (kN / tonF) / (KN / tonF) Work Force	
			Anfangskraft / Initial Load	Endkraft / Final Load	1 Mio. Hübe / strokes Standard-Arbeitskraft / Standard Working Force	300.000 Hübe / strokes Zulässige Arbeitskraft / Allowable Working Force
Schraubendruckfeder / Coil Spring	00° - 40	TF40-100	602.4 / 61.4	3614.4 / 368.6	98.0 / 10.0	147.0 / 15.0
	00° - 60	TF40-150	651.3 / 66.3	3657.3 / 372.3		

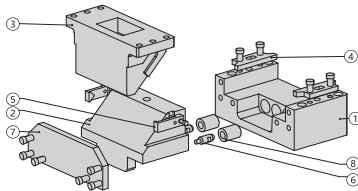

Nr. / No.	Beschreibung / Description	Anzahl / Qty	Material und Anmerkung / Material and Remark
①	Aufnahme / Cam Holder	1	HT300
②	Schieber / Cam Slider	1	HT300+Festschmierstoff / graphite plugs
③	Treiber / Cam Driver	1	HT300+Festschmierstoff / graphite plugs
④	Platte / Slide Plate	2	42CrMo+Festschmierstoff / graphite plugs
⑤	Zwangsrückführung / Position Return Follower	1	St45
⑥	Federführungsbolzen / Spring Guide Pin	2	St45
⑦	Stoppblock / Baffle	1	St45
⑧	Feder / Spring	2	Typ / Type

Bestellnummer / Order Number

	Bestellnr. / Catalog No.	(W)	(α)	WT
	KMACG	250	00	40





KBDA300

Fertiges Stifflloch / Dowel Pin Hole Finished

KBD300

Vorbereitetes Stifflloch / Dowel Pin Prepared Hole



Tabelle Schieber
Table of Cam Structure

Bestellnr. / Catalog No.	W	X ₁	X ₂	X ₃	X ₄	X ₅	X ₆	X ₇	X ₈	Z ₁	Gewicht (kg) / Weight (kg)
KBDA / KBD300-00-40	300	210	135	140	100	70	200	105	246	170	106.0
KBDA / KBD300-00-60	300	230	155	160	120	80	220	125	266	190	127.0



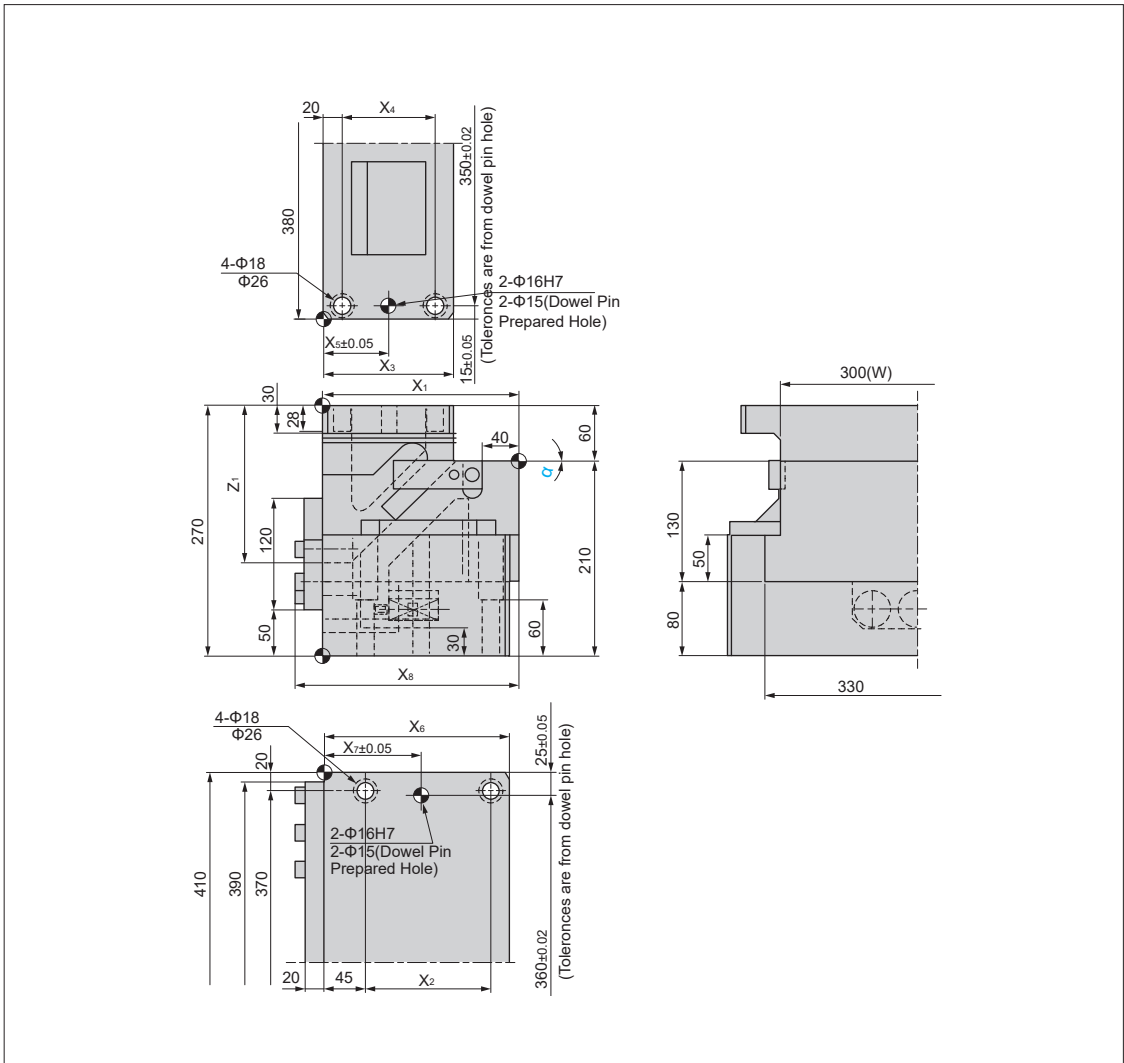
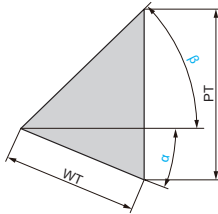

Bestellnr. / Catalog N.	α	β	WT	PT
KBDA / KBD300-00-40	0	45	40	40
KBDA / KBD300-00-60	0	45	60	60

**Übersicht Schieberkraft / Rückzugskraft
Table of Cam Force**

Typ / Type	α -WT	Modell / Model	Federkraft (N/kgf) / Spring Force (N / kgf)		Arbeitskraft (kN / tonF) / (KN / tonF) Work Force	
			Anfangskraft / Initial Load	Endkraft / Final Load	1 Mio. Hübe / strokes Standard-Arbeitskraft / Standard Working Force	300.000 Hübe / strokes Zulässige Arbeitskraft / Allowable Working Force
Schraubendruckfeder / Coil Spring	00° - 40	TF40-100	602.4 / 61.4	3614.4 / 368.6	117.6 / 12.0	176.4 / 18.0
	00° - 60	TF40-150	651.3 / 66.3	3657.3 / 372.3		

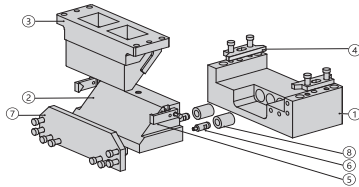

Nr. / No.	Beschreibung / Description	Anzahl / Qty	Material und Anmerkung / Material and Remark
①	Aufnahme / Cam Holder	1	HT300
②	Schieber / Cam Slider	1	HT300+Festschmierstoff / graphite plugs
③	Treiber / Cam Driver	1	HT300+Festschmierstoff / graphite plugs
④	Platte / Slide Plate	2	42CrMo+Festschmierstoff / graphite plugs
⑤	Zwangsrückführung / Position Return Follower	1	St45
⑥	Federführungsbolzen / Spring Guide Pin	2	St45
⑦	Stoppblock / Baffle	1	St45
⑧	Feder / Spring	2	Typ / Type

Bestellnummer / Order Number

	Bestellnr. / Catalog No.	-	(W)	-	(α)	-	WT
	KMACG	-	300	-	00	-	40





KBDA400

Fertiges Stiftloch / Dowel Pin Hole Finished

KBD400

Vorbereitetes Stiftloch / Dowel Pin Prepared Hole

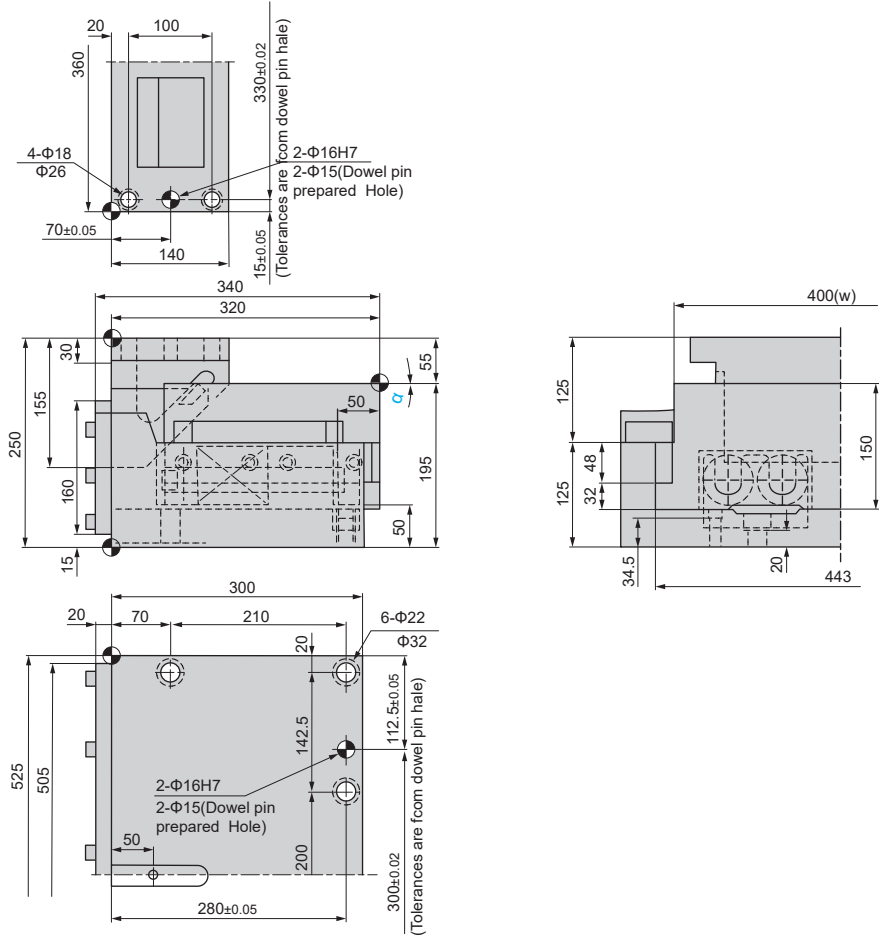

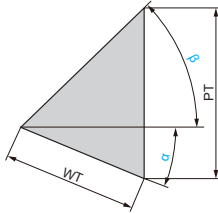

Bestellnr. / Catalog No.	α	β	WT	PT
KBDA / KBD400-00-40	0	45	60	60

**Übersicht Schieberkraft / Rückzugskraft
Table of Cam Force**

Typ / Type	α -WT	Modell / Model	Federkraft (N/kgf) / Spring Force (N / kgf)		Arbeitskraft (kN / tonF) / (KN / tonF) Work Force	
			Anfangskraft / Initial Load	Endkraft / Final Load	1 Mio. Hübe / strokes Standard-Arbeitskraft / Standard Working Force	300.000 Hübe / strokes Zulässige Arbeitskraft / Allowable Working Force
Schraubendruckfeder / Coil Spring	00° - 60	301.6 / 30.7	9349.6 / 952.3	137.2 / 14.0	205.8 / 21.0	197.9

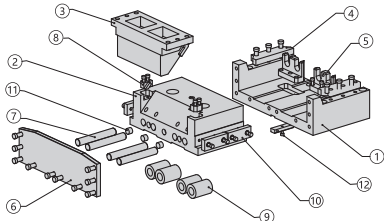

Nr. / No.	Beschreibung / Description	Anzahl / Qty	Material und Anmerkung / Material and Remark
①	Aufnahme / Cam Holder	1	HT300
②	Schieber / Cam Slider	1	HT300
③	Treiber / Cam Driver	1	HT300
④	Gleitplatte / Upper Plate	2	42CrMo
⑤	Halteplatte / Stopper Plate	1	St45
⑥	Federhalteplatte / Spring Stopper Plate	2	St45
⑦	Federführungsbolzen / Spring Guide Pin	4	St45
⑧	Zwangsrückführung / Position Return Follower	2	St45
⑨	Feder / Spring	4	TF60-150
⑩	Gleitplatte / Guide Block	4	42CrMo
⑪	Urethan-Dämpfer / Urethane Stopper	3	Urethan
⑫	Passfeder / Key	1	St45

Bestellnummer / Order Number

☎	Bestellnr. / Catalog No.	(W)	(α)	WT
	KBDA	400	00	60

KBDA - 400 - 00 - 60 - K

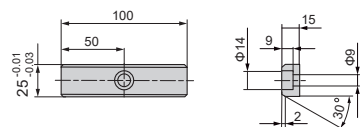
 Ausführung Passfeder /
Key specification



KBDA500

Fertiges Stiftloch / Dowel Pin Hole Finished

KBD500

Vorbereitetes Stiftloch / Dowel Pin Prepared Hole

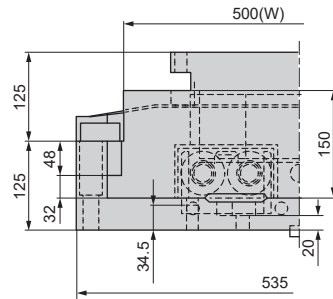
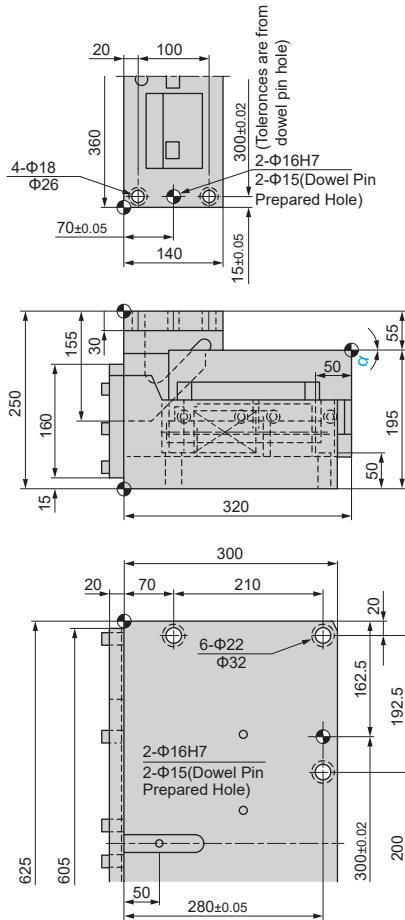

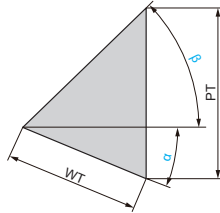

Bestellnr. / Catalog No.	α	β	WT	PT
KBDA / KBD500-00-60	0	45	60	60

**Übersicht Schieberkraft / Rückzugskraft
Table of Cam Force**

Typ / Type	α-WT	Federkraft (N/kgf) / Spring Force (N / kgf)		Arbeitskraft (kN / tonF) / (KN / tonF) Work Force		Gewicht (kg) / Weight (kg)
		Anfangskraft / Initial Load	Endkraft / Final Load	1 Mio. Hübe / strokes Standard-Arbeitskraft / Standard Working Force	300.000 Hübe / strokes Zulässige Arbeitskraft / Allowable Working Force	
Schraubendruckfeder / Coil Spring	00° - 60	301.6 / 30.7	9349.6 / 952.3	137.2 / 14.0	205.8 / 21.0	240.6

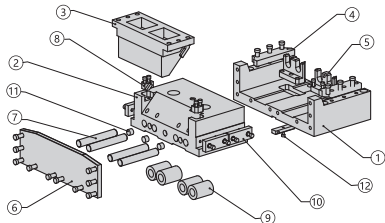

Nr. / No.	Beschreibung / Description	Anzahl / Qty	Material und Anmerkung / Material and Remark
①	Aufnahme / Cam Holder	1	HT300
②	Schieber / Cam Slider	1	HT300
③	Treiber / Cam Driver	1	HT300
④	Gleitplatte / Upper Plate	2	42CrMo
⑤	Halteplatte / Stopper Plate	1	St45
⑥	Federhalteplatte / Spring Stopper Plate	2	St45
⑦	Federführungsbolzen / Spring Guide Pin	4	St45
⑧	Zwangsrückführung / Position Return Follower	2	St45
⑨	Feder / Spring	4	TF60-150
⑩	Gleitplatte / Guide Block	4	42CrMo
⑪	Urethan-Dämpfer / Urethane Stopper	3	Urethan
⑫	Passfeder / Key	1	St45

Bestellnummer / Order Number

☎	Bestellnr. / Catalog No.	(W)	(α)	WT
	KBDA	500	00	60

KBDA - 500 - 00 - 60 - K

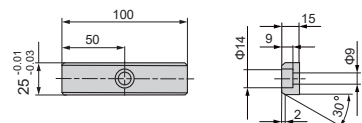
 Ausführung Passfeder /
Key specification



KBDA600

Fertiges Stiftloch / Dowel Pin Hole Finished

KBD600

Vorbereitetes Stiftloch / Dowel Pin Prepared Hole

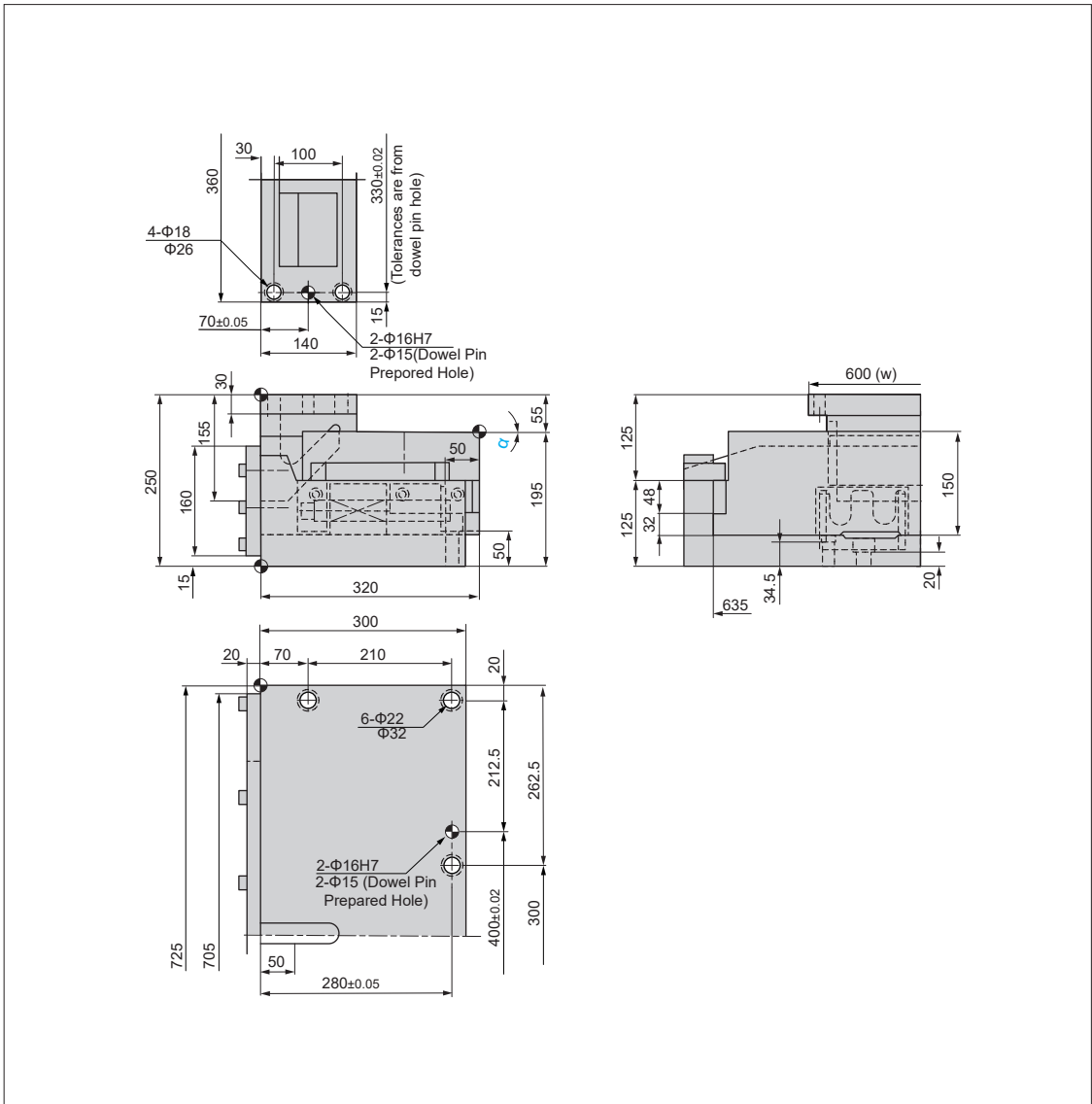

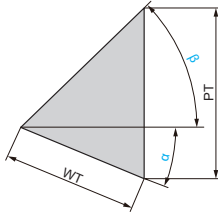

Bestellnr. / Catalog No.	α	β	WT	PT
KBDA / KBD600-00-60	0	45	60	60

Übersicht Schieberkraft / Rückzugskraft Table of Cam Force

Typ / Type	α -WT	Federkraft (N/kgf) / Spring Force (N / kgf)		Arbeitskraft (kN / tonF) / (KN / tonF) Work Force		Gewicht (kg) / Weight (kg)
		Anfangskraft / Initial Load	Endkraft / Final Load	1 Mio. HÜBE / strokes Standard-Arbeitskraft / Standard Working Force	300.000 HÜBE / strokes Zulässige Arbeitskraft / Allowable Working Force	
Schraubendruckfeder / Coil Spring	00° - 60	301.6 / 30.7	9349.6 / 952.3	137.2 / 14.0	205.8 / 21.0	280.6

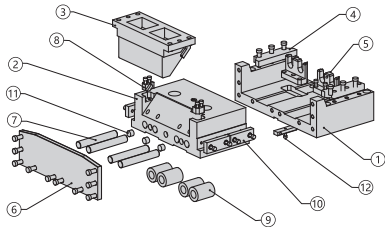

Nr. / No.	Beschreibung / Description	Anzahl / Qty	Material und Anmerkung / Material and Remark
①	Aufnahme / Cam Holder	1	HT300
②	Schieber / Cam Slider	1	HT300
③	Treiber / Cam Driver	1	HT300
④	Gleitplatte / Upper Plate	2	42CrMo
⑤	Halteplatte / Stopper Plate	1	St45
⑥	Federhalteplatte / Spring Stopper Plate	2	St45
⑦	Federführungsbolzen / Spring Guide Pin	4	St45
⑧	Zwangsrückführung / Position Return Follower	2	St45
⑨	Feder / Spring	4	TF60-150
⑩	Gleitplatte / Guide Block	4	42CrMo
⑪	Urethan-Dämpfer / Urethane Stopper	3	Urethan
⑫	Passfeder / Key	1	St45

Bestellnummer / Order Number

☎	Bestellnr. / Catalog No.	(W)	(α)	WT
	KBDA	600	00	60

KBDA - 600 - 00 - 60 - K

Ausführung Passfeder /
Key specification

