

KDMVC50

**Tabelle Schieber
Table of Cam Structure**

Bestellnr. / Catalog No.	W	X ₁	X ₂	Z ₁	Z ₂	Gewicht (kg) / Weight (kg)
KDMVC50-00	50	260	40	136.2	191	19.1
KDMVC50-05	50	260.76	50	128.6	180.73	19.2
KDMVC50-10	50	263.12	55	118.1	169.8	19.4
KDMVC50-15	50	260.02	65	107.4	162.25	19.9
KDMVC50-20	50	261.41	70	96.1	155.12	20.5

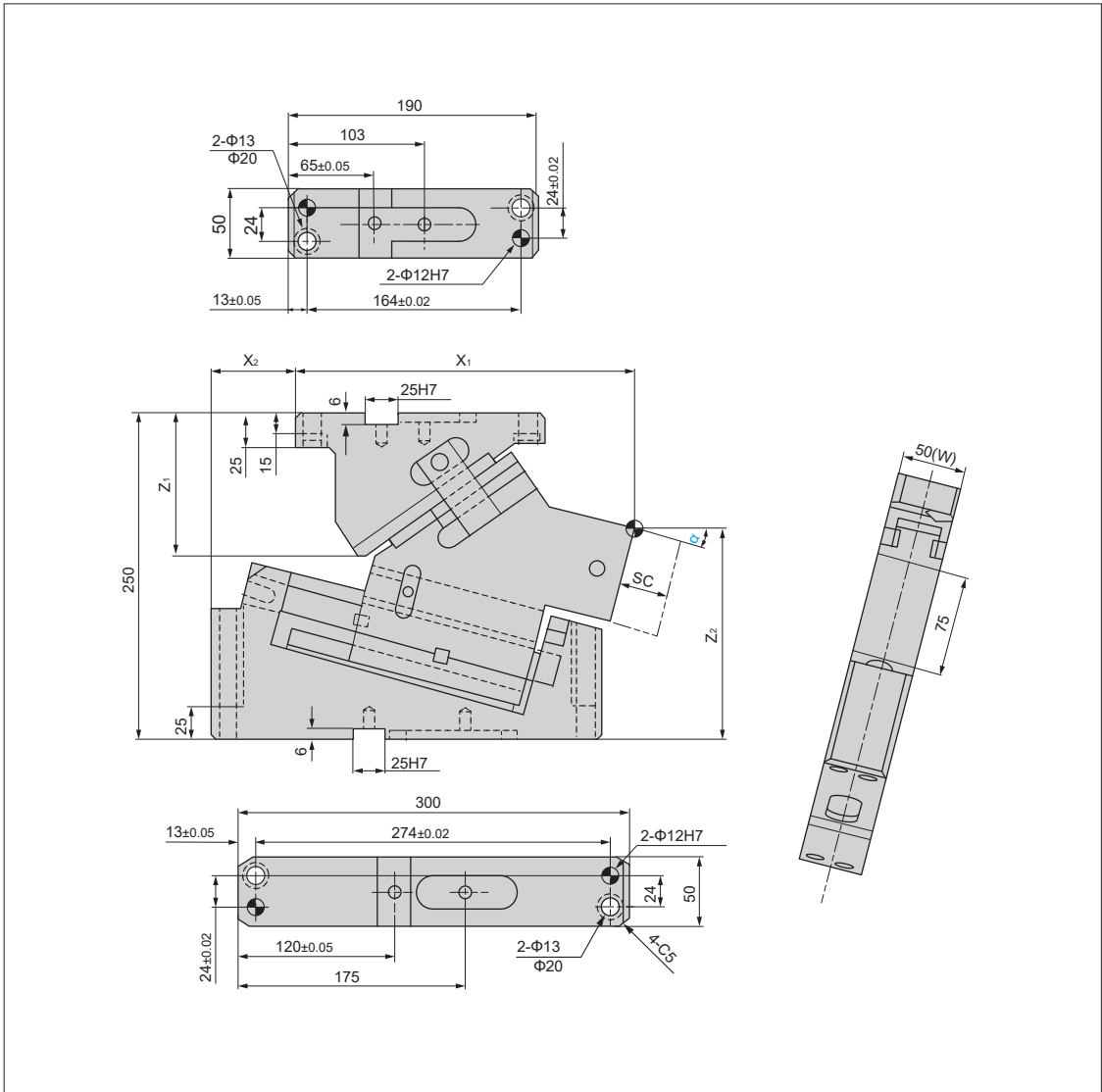

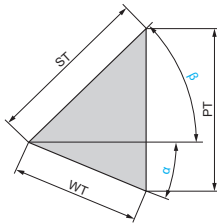

Bestellnr. / Catalog No.	α	β	WT	ST	PT
KDMVC50-00	0	50	55	85.6	65.5
KDMVC50-05	5	45	55	77.5	59.6
KDMVC50-10	10	40	55	70.7	55
KDMVC50-15	15	35	55	64.9	51.4
KDMVC50-20	20	30	55	59.7	48.7

**Übersicht Schieberkraft / Rückzugskraft
Table of Cam Force**

Typ / Type	α	Federkraft (kN/kp) / Spring Force (KN / kgf)		Arbeitskraft (kN / tonF) / (KN / tonF) Work Force	
		Anfangskraft / Initial Load	Endkraft / Final Load	1 Mio. Hübe / strokes Standard-Arbeitskraft / Standard Working Force	Gasdruckfeder / Gas Spring
GK	00° ~ 20°	2.00 / 204	2.27 / 231.6	29.4 / 3.0	M2-200-63 (KALLER)
CS	00° ~ 20°		3.04 / 310		SFNA200-63 (SANKYO)
GD	00° ~ 20°		2.72 / 277.5		C180-63 (DADCO)

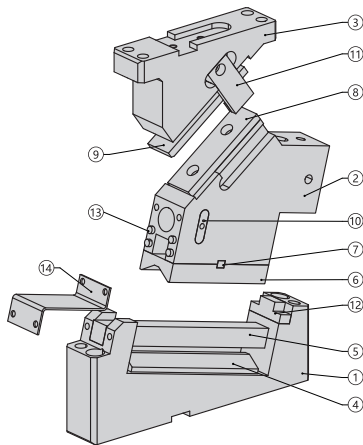

Nr. / No.	Beschreibung / Description	Anzahl / Qty	Material und Anmerkung / Material and Remark
①	Aufnahme / Cam Holder	1	QT550
②	Schieber / Cam Slider	1	QT550
③	Treiber / Cam Driver	1	QT550
④	V-Prisma / V Guide Block	1	Bronze+Festschmierstoff / graphite plugs
⑤	Führungsleiste / Guide Rod	1	42CrMo
⑥	Gleitplatte / U Guide Block	1	42CrMo+Festschmierstoff / graphite plugs
⑦	Passfeder / Key	2	St45
⑧	Gleitplatte / Guide Block	1	42CrMo
⑨	Gleitplatte / Guide Block	1	Bronze+Festschmierstoff / graphite plugs
⑩	Federblock / Spring Block	2	St45
⑪	Zwangsrückführung / Positive Return Follower	2	St45
⑫	Federplatte / Spring stopper	1	St45
⑬	Urethan-Dämpfer / Urethane Stopper	4	Urethan
⑭	Sicherungsblech / Lock Plate	1	Stahl 20
⑮	Gasdruckfeder / Gas Spring	1	Typ / Type

Options-Code / Option Code	Beschreibung / Envelope
K	Passfeder ist montiert / Dedicated key is attached
SC	Die Arbeitsfläche kann im Bereich von 1 bis 40 mm in 10 mm Schritten verlängert werden. / The mount surface is extended forward in the range of 1 to 40 mm (in increments of 10 mm)

Bestellnummer / Order Number

☎	Bestellnr. / Catalog No.	-	(W)	-	(α)	-	Typ / Type
	KDMVC	-	50	-	20	-	GK
	KDMVC	-	50	-	20	-	SC10

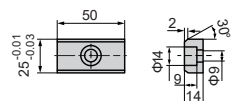
 Ausführung Passfeder /
Key specification

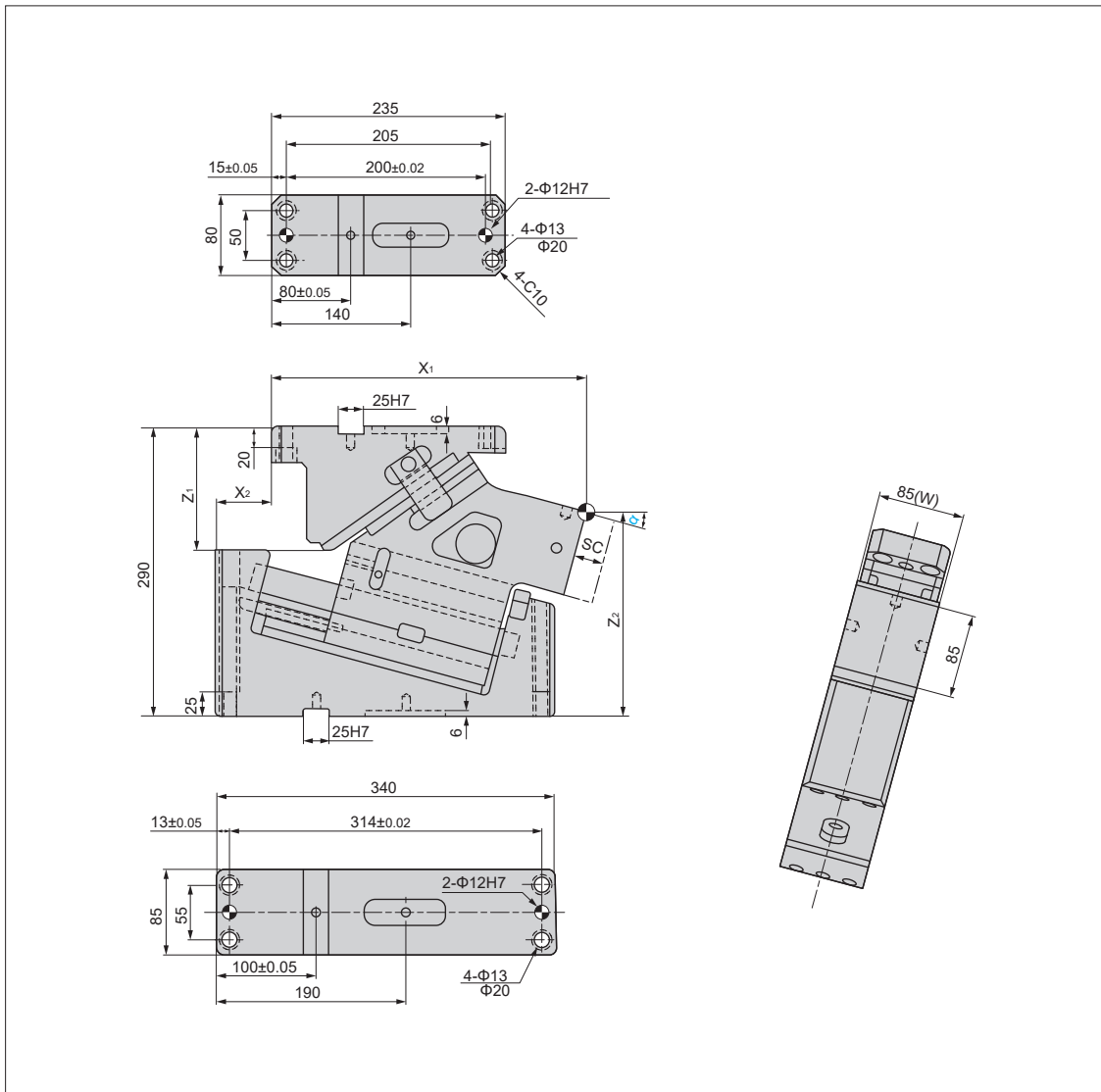
KDMVC85

**Tabelle Schieber
Table of Cam Structure**

Bestellnr. / Catalog No.	W	X ₁	X ₂	Z ₁	Z ₂	Gewicht (kg) / Weight (kg)
KDMVC85-00	85	325	15	158.4	235	44.6
KDMVC85-05	85	324.32	30	146.6	225.4	44.8
KDMVC85-10	85	318.2	45	134.9	215.01	45.1
KDMVC85-15	85	316.58	55	122.6	204.86	45.9
KDMVC85-20	85	309.39	70	109.6	195.01	46.8



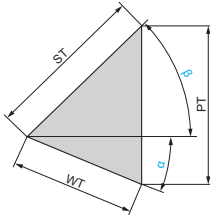

Bestellnr. / Catalog No.	α	β	WT	ST	PT
KDMVC85-00	0	50	70	108.9	83.4
KDMVC85-05	5	45	70	98.6	75.8
KDMVC85-10	10	40	70	90	70
KDMVC85-15	15	35	70	82.5	65.5
KDMVC85-20	20	30	70	76	61.9

**Übersicht Schieberkraft / Rückzugskraft
Table of Cam Force**

Typ / Type	α	Federkraft (kN/kp) / Spring Force (KN / kgf)		Arbeitskraft (kN / tonF) / (KN / tonF) Work Force	
		Anfangskraft / Initial Load	Endkraft / Final Load	1 Mio. Hübe / strokes Standard-Arbeitskraft / Standard Working Force	Gasdruckfeder / Gas Spring
GK	00° ~ 20°	2.65 / 270.4	3.50 / 357	58.8 / 6.0	TU250-80 (KALLER)
CS	00° ~ 20°	2.50 / 255	3.49 / 356		SPF250-80 (SANKYO)
GD	00° ~ 20°	2.96 / 302	4.00 / 408		90.3.00300-080 (DADCO)

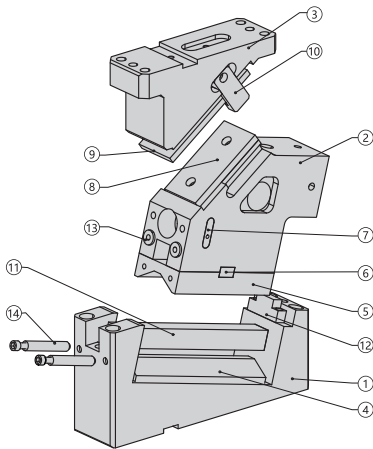

Nr. / No.	Beschreibung / Description	Anzahl / Qty	Material und Anmerkung / Material and Remark
①	Aufnahme / Cam Holder	1	QT550
②	Schieber / Cam Slider	1	QT550
③	Treiber / Cam Driver	1	QT550
④	V-Prisma / V Guide Block	1	Bronze+Festschmierstoff / graphite plugs
⑤	Gleitplatte / U Guide Block	1	42CrMo+Festschmierstoff / graphite plugs
⑥	Passfeder / Key	2	St45
⑦	Federblock / Spring Block	1	St45
⑧	Gleitplatte / Guide Block	1	42CrMo
⑨	Gleitplatte / Guide Block	1	Bronze+Festschmierstoff / graphite plugs
⑩	Zwangsrückführung / Positive Return Follower	2	St45
⑪	Führungsleiste / Guide Rod	1	42CrMo
⑫	Federplatte / Spring stopper	1	St45
⑬	Urethan-Dämpfer / Urethane Stopper	2	Urethan
⑭	Distanzhülse / Lock Spacer	2	Q235
⑮	Gasdruckfeder / Gas Spring	1	Typ / Type

Options-Code / Option Code	Beschreibung / Envelope
K	Passfeder ist montiert / Dedicated key is attached
SC	Die Arbeitsfläche kann im Bereich von 1 bis 40 mm in 10 mm Schritten verlängert werden. / The mount surface is extended forward in the range of 1 to 40 mm (in increments of 10 mm)

Bestellnummer / Order Number

☎	Bestellnr. / Catalog No.	(W)	(α)	Typ / Type
	KDMVC	85	20	GK
	KDMVC	85	20	SC10

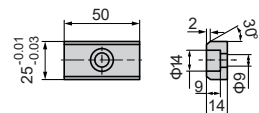
 Ausführung Passfeder /
Key specification



KDMVC110



Tabelle Schieber
Table of Cam Structure

Bestellnr. / Catalog No.	W	X ₁	X ₂	Z ₁	Z ₂	Gewicht (kg) / Weight (kg)
KDMVC110-00	110	360	25	177.8	250	70.4
KDMVC110-05	110	361.59	40	168.5	235.56	70.3
KDMVC110-10	110	352.76	65	153.4	226.13	71.1
KDMVC110-15	110	353.41	75	138.7	215.75	73.0
KDMVC110-20	110	438.46	90	124.7	204.47	74.9



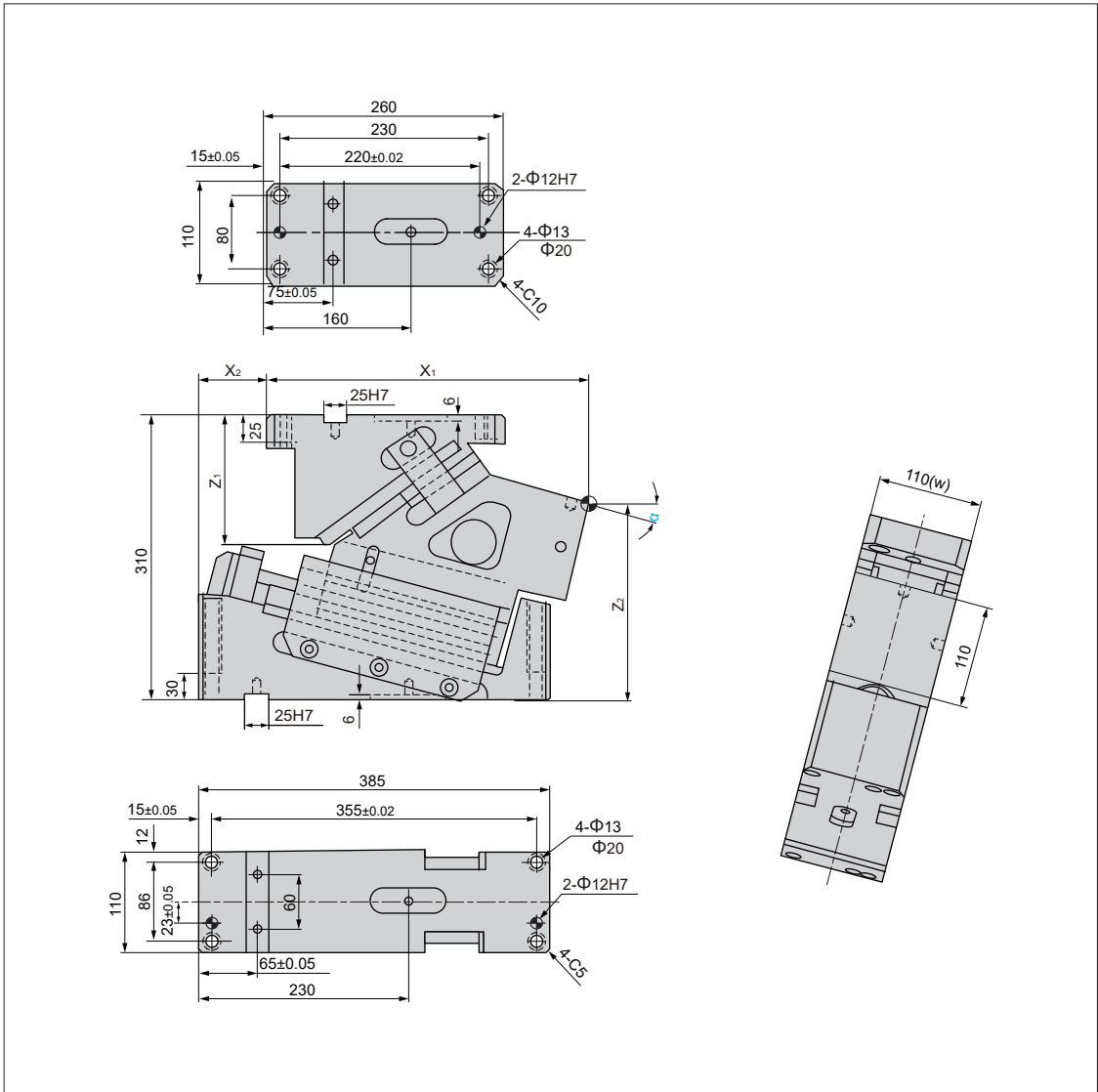
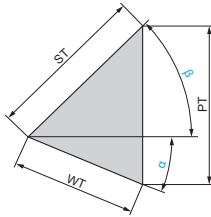

Bestellnr. / Catalog No.	α	β	WT	ST	PT
KDMVC110-00	0	50	70	108.9	83.4
KDMVC110-05	5	45	70	98.6	75.8
KDMVC110-10	10	40	70	90	70
KDMVC110-15	15	35	70	82.5	65.5
KDMVC110-20	20	30	70	76	61.9

**Übersicht Schieberkraft / Rückzugskraft
Table of Cam Force**

Typ / Type	α	Federkraft (kN/kp) / Spring Force (KN / kgf)		Arbeitskraft (kN / tonF) / (KN / tonF) Work Force	
		Anfangskraft / Initial Load	Endkraft / Final Load	1 Mio. Hübe / strokes Standard-Arbeitskraft / Standard Working Force	Gasdruckfeder / Gas Spring
GK	00° ~ 20°	4.7 / 479	6.7 / 683.6	58.8 / 6.0	TU500-80 (KALLER)
CS	00° ~ 20°	5.0 / 510	6.59 / 672		SPF500-80 (SANKYO)
GD	00° ~ 20°	4.7 / 479	6.10 / 622		90.10.00500-080 (DADCO)

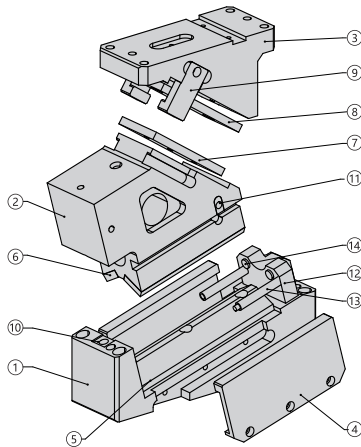

Nr. / No.	Beschreibung / Description	Anzahl / Qty	Material und Anmerkung / Material and Remark
①	Aufnahme / Cam Holder	1	QT550
②	Schieber / Cam Slider	1	QT550
③	Treiber / Cam Driver	1	QT550
④	Führungsleiste / Side Plate	2	St45
⑤	V-Prisma / V Guide Block	1	St45
⑥	Gleitplatte / Guide Block	2	Bronze+Festschmierstoff / graphite plugs
⑦	Gleitplatte / Guide Block	1	42CrMo
⑧	Gleitplatte / Guide Block	1	Bronze+Festschmierstoff / graphite plugs
⑨	Zwangsrückführung / Positive Return Follower	3	St45
⑩	Federplatte / Spring stopper	1	St45
⑪	Federblock / Spring Block	2	St45
⑫	Anschlagblock / Stop Block	1	St45
⑬	Distanzhülse / Lock Spacer	2	Q235
⑭	Urethan-Dämpfer / Urethane Stopper	2	Urethan
⑮	Gasdruckfeder / Gas Spring	1	Typ / Type

Options-Code / Option Code	Beschreibung / Envelope
K	Passfeder ist montiert / Dedicated key is attached

Bestellnummer / Order Number

☎	Bestellnr. / Catalog No.	(W)	(α)	Typ / Type
	KDMVC	110	20	GK

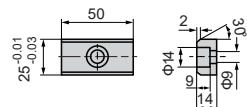
 Ausführung Passfeder /
Key specification



KDMVC150



Tabelle Schieber
Table of Cam Structure

Bestellnr. / Catalog No.	W	X ₁	X ₂	Z ₁	Z ₂	Gewicht (kg) / Weight (kg)
KDMVC150-00	150	355	35	189	250	99.4
KDMVC150-05	150	362.59	45	175.8	237.48	100.3
KDMVC150-10	150	358.74	65	161.7	224.96	100.7
KDMVC150-15	150	364.37	70	147.1	212.49	103.2
KDMVC150-20	150	364.4	80	132	200.13	105.9



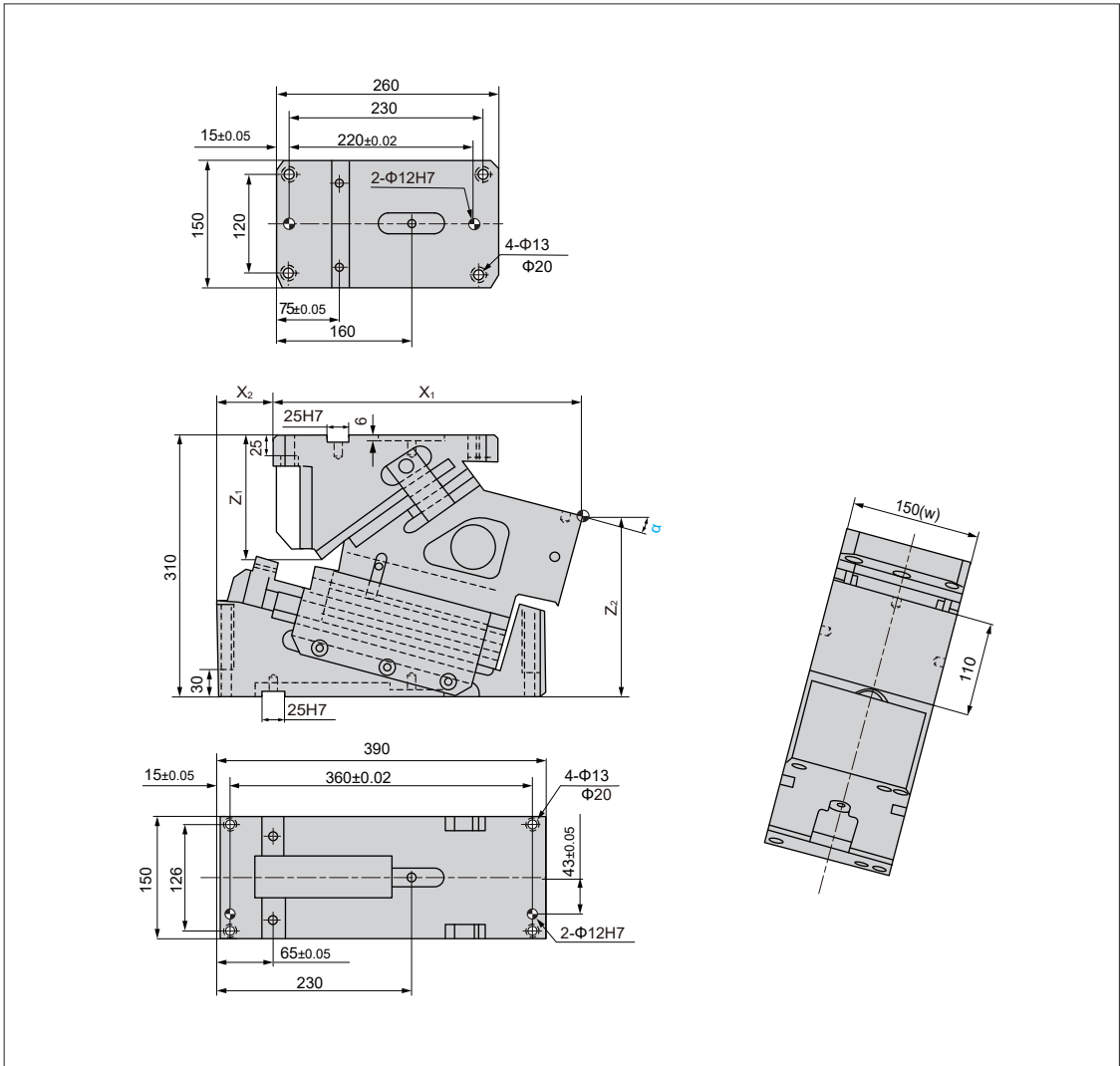
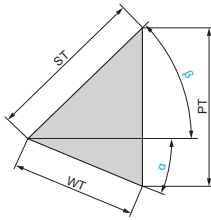

Bestellnr. / Catalog No.	α	β	WT	ST	PT
KDMVC150-00	0	50	70	108.9	83.4
KDMVC150-05	5	45	70	98.6	75.8
KDMVC150-10	10	40	70	90	70
KDMVC150-15	15	35	70	82.5	65.5
KDMVC150-20	20	30	70	76	61.9

**Übersicht Schieberkraft / Rückzugskraft
Table of Cam Force**

Typ / Type	α	Federkraft (kN/kp) / Spring Force (KN / kgf)		Arbeitskraft (kN / tonF) / (KN / tonF) Work Force	
		Anfangskraft / Initial Load	Endkraft / Final Guide	1 Mio. Hübe / strokes Standard-Arbeitskraft / Standard Working Force	Gasdruckfeder / Gas Spring
GK	00° ~ 20°	7.4 / 755	12.00 / 1224	166.7/17.0	TU750-80 (KALLER)
CS	00° ~ 20°	7.5 / 765	12.01 / 1225.5		SPF750-80 (SANKYO)
GD	00° ~ 20°	7.4 / 755	11.2/		90.10.00750-080 (DADCO)

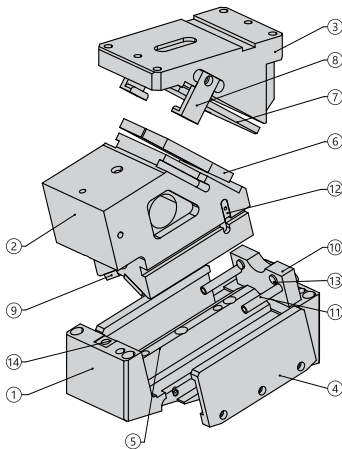

Nr. / No.	Beschreibung / Description	Anzahl / Qty	Material und Anmerkung / Material and Remark
①	Aufnahme / Cam Holder	1	QT550
②	Schieber / Cam Slider	1	QT550
③	Treiber / Cam Driver	1	QT550
④	Führungsleiste / Side Plate	2	Bronze+Festschmierstoff / graphite plugs
⑤	V-Prisma / V Guide Block	1	St45
⑥	Gleitplatte / Guide Block	2	42CrMo
⑦	Gleitplatte / Guide Block	2	Stahl 45+Festschmierstoff / graphite plugs
⑧	Zwangsrückführung / Positive Return Follower	2	St45
⑨	Gleitplatte / Guide Block	2	Bronze+Festschmierstoff / graphite plugs
⑩	Anschlagblock / Stop Block	1	St45
⑪	Distanzhülse / Lock Spacer	2	Q235
⑫	Federblock / Spring Block	1	St45
⑬	Urethan-Dämpfer / Urethane Stopper	2	Urethan
⑭	Federblock / Spring Block	1	St45
⑮	Gasdruckfeder / Gas Spring	1	Typ / Type

Bestellnummer / Order Number

	Bestellnr. / Catalog No.	(W)	(α)	Typ / Type
	KDMVC	150	20	GK

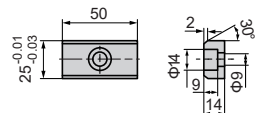
 Ausführung Passfeder /
Key specification

KDMVC220

Tabelle Schieber
Table of Cam Structure

Bestellnr. / Catalog No.	W	X ₁	X ₂	Z ₁	Z ₂	Gewicht (kg) / Weight (kg)
KDMVC220-00	220	355	35	177.6	247	139
KDMVC220-05	220	356.59	50	165.9	234.56	140
KDMVC220-10	220	347.76	75	152.6	223.13	141
KDMVC220-15	220	348.41	85	138.6	211.75	145
KDMVC220-20	220	346.46	97	124.3	200.47	150



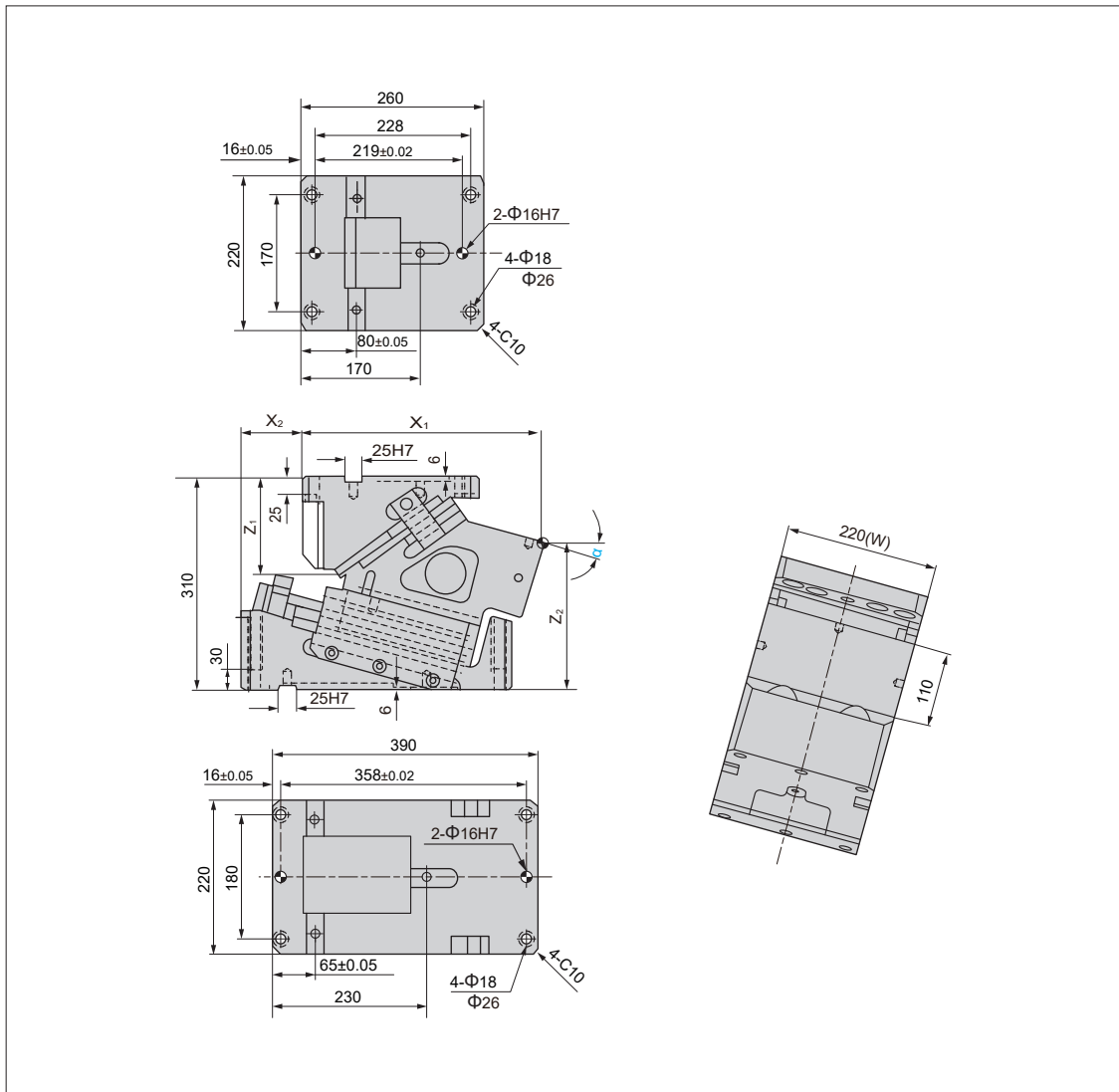
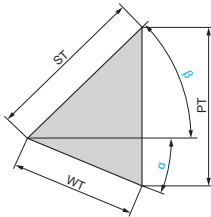

Bestellnr. / Catalog No.	α	β	WT	ST	PT
KDMVC220-00	0	50	70	108.9	83.4
KDMVC220-05	5	45	70	98.6	75.8
KDMVC220-10	10	40	70	90	70
KDMVC220-15	15	35	70	82.5	65.5
KDMVC220-20	20	30	70	76	61.9

**Übersicht Schieberkraft / Rückzugskraft
Table of Cam Force**

Typ / Type	α	Federkraft (kN/kp) / Spring Force (KN / kgf)		Arbeitskraft (kN / tonF) / (KN / tonF) Work Force	
		Anfangskraft / Initial Load	Endkraft / Final Load	1 Mio. Hübe / strokes Standard-Arbeitskraft / Standard Working Force	Gasdruckfeder / Gas Spring
GK	00° ~ 20°	9.4 / 959	13.4 / 1367.4	245.2 / 25.0	TU500-80 (KALLER)
CS	00° ~ 20°	10 / 1020	13.18 / 1344.9		SPF500-80 (SANKYO)
GD	00° ~ 20°	9.4 / 959	12.2 / 1244.9		90.10.00500.080 (DADCO)

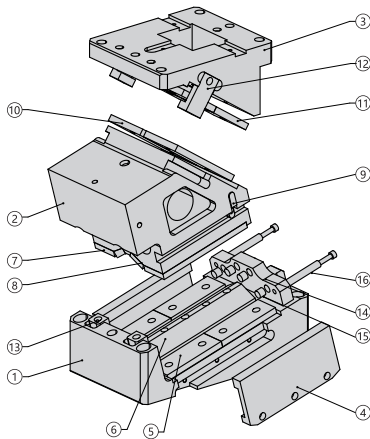

Nr. / No.	Beschreibung / Description	Anzahl / Qty	Material und Anmerkung / Material and Remark
①	Aufnahme / Cam Holder	1	QT550
②	Schieber / Cam Slider	1	QT550
③	Treiber / Cam Driver	1	QT550
④	Führungsleiste / Side Plate	2	St45
⑤	Gleitplatte / Guide Block	4	42CrMo
⑥	V-Prisma / V Guide Block	1	St45
⑦	Gleitplatte / Guide Block	2	Bronze+Festschmierstoff / graphite plugs
⑧	Gleitplatte / Guide Block	2	Bronze+Festschmierstoff / graphite plugs
⑨	Federblock / Spring Block	2	St45
⑩	Gleitplatte / Guide Block	2	42CrMo
⑪	Gleitplatte / Guide Block	4	Bronze+Festschmierstoff / graphite plugs
⑫	Zwangsrückführung / Positive Return Follower	2	St45
⑬	Federblock / Spring Block	2	St45
⑭	Anschlagblock / Stop Block	1	St45
⑮	Urethan-Dämpfer / Urethane Stopper	4	Urethan
⑯	Distanzhülse / Lock Spacer	2	Q235
⑰	Gasdruckfeder / Gas Spring	1	Typ / Type

Options-Code / Option Code	Beschreibung / Envelope
K	Passfeder ist montiert / Dedicated key is attached

Bestellnummer / Order Number

	Bestellnr. / Catalog No.	(W)	(α)	Typ / Type
	KDMVC	220	20	GK

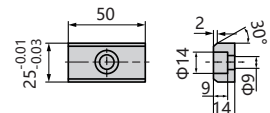
 Ausführung Passfeder /
Key specification

KDMVC330

Tabelle Schieber
Table of Cam Structure

Bestellnr. / Catalog No.	W	X ₁	X ₂	Z ₁	Z ₂	Gewicht (kg) / Weight (kg)
KDMVC330-00	330	335	65	195	326	251
KDMVC330-05	330	334.2	90	185.8	316.67	251
KDMVC330-10	330	337.94	105	172.7	305.68	253
KDMVC330-15	330	336.09	125	161.5	292.08	253
KDMVC330-20	330	333.52	145	145.4	282.93	262



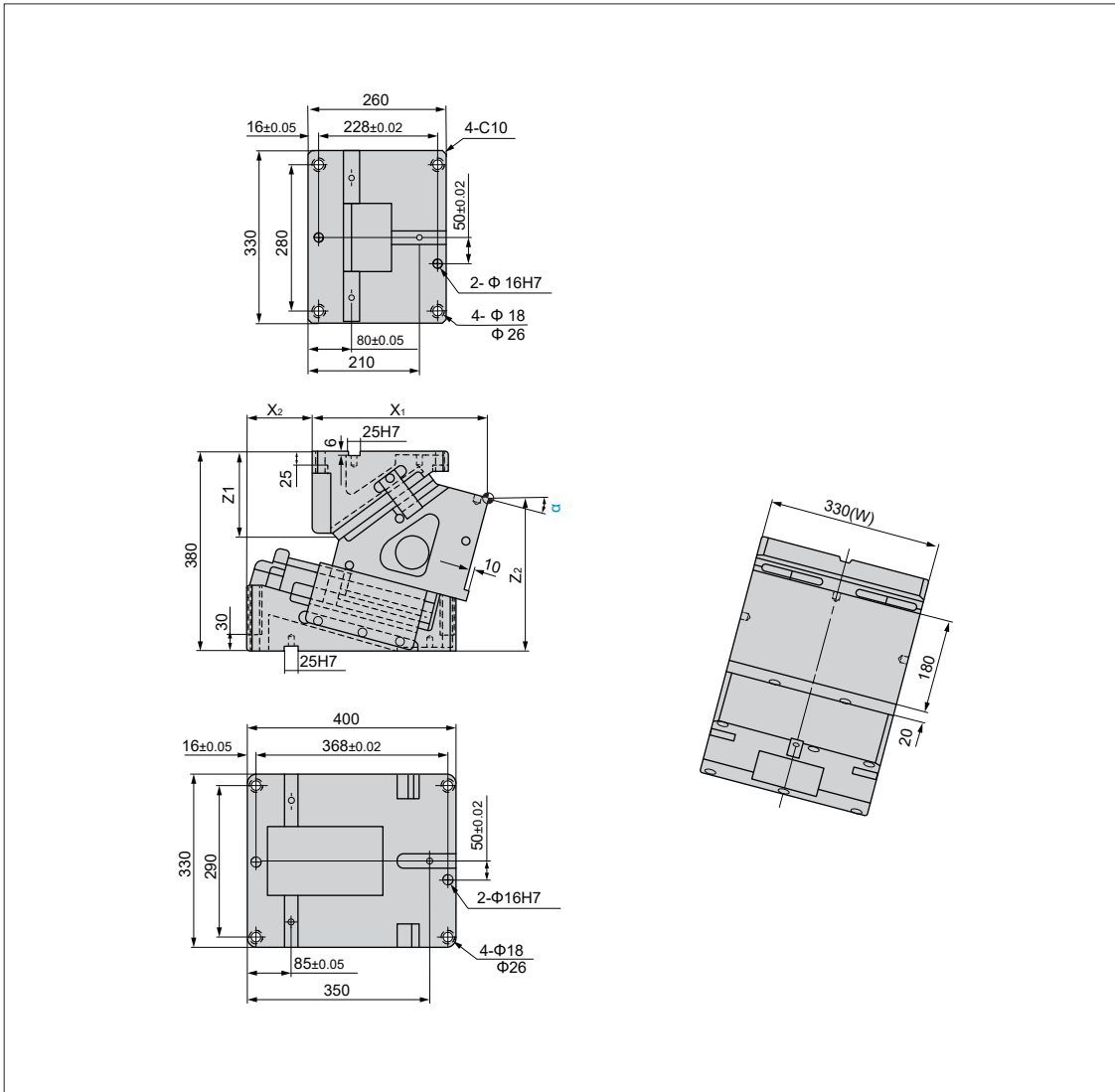
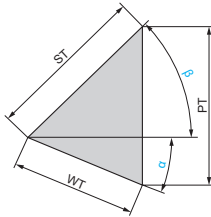

Bestellnr. / Catalog No.	α	β	WT	ST	PT
KDMVC330-00	0	50	80	124.5	95.3
KDMVC330-05	5	45	80	112.7	86.7
KDMVC330-10	10	40	80	102.8	80
KDMVC330-15	15	35	80	94.3	74.8
KDMVC330-20	20	30	80	86.8	70.8

**Übersicht Schieberkraft / Rückzugskraft
Table of Cam Force**

Typ / Type	α	Federkraft (kN/kp) / Spring Force (KN / kgf)		Arbeitskraft (kN / tonF) / (KN / tonF) Work Force	
		Anfangskraft / Initial Load	Endkraft / Final Load	1 Mio. Hübe / strokes Standard-Arbeitskraft / Standard Working Force	Gasdruckfeder / Gas Spring
GK	00° ~ 20°	14.8 / 1510	22 / 2243	343.2 / 35.0	K750-100 (KALLER)
CS	00° ~ 20°	15 / 1530.6	24.5 / 2500	343.2 / 35.0	SM.750.100 (SANKYO)
GD	00° ~ 20°	14.8 / 1510	22 / 2243	343.2 / 35.0	90.3.00750.100 (DADCO)

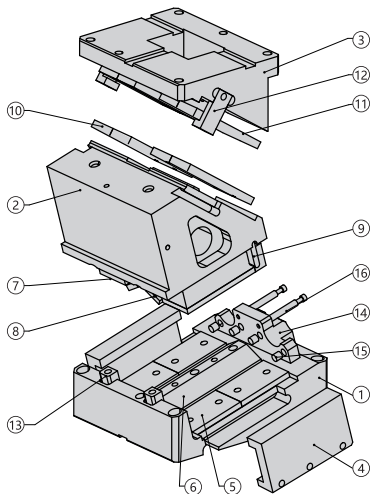

Nr. / No.	Beschreibung / Description	Anzahl / Qty	Material und Anmerkung / Material and Remark
①	Aufnahme / Cam Holder	1	QT550
②	Schieber / Cam Slider	1	QT550
③	Treiber / Cam Driver	1	QT550
④	Führungsleiste / Side Plate	1	St45
⑤	Gleitplatte / Guide Block	4	42CrMo
⑥	V-Prisma / V Guide Block	1	St45
⑦	Gleitplatte / Guide Block	2	Bronze+Festschmierstoff / graphite plugs
⑧	Gleitplatte / Guide Block	2	Bronze+Festschmierstoff / graphite plugs
⑨	Federblock / Spring Block	2	St45
⑩	Gleitplatte / Guide Block	1	42CrMo
⑪	Gleitplatte / Guide Block	4	Bronze+Festschmierstoff / graphite plugs
⑫	Zwangsrückführung / Positive Return Follower	2	St45
⑬	Federblock / Spring Block	2	St45
⑭	Anschlagblock / Stop Block	1	St45
⑮	Urethan-Dämpfer / Urethane Stopper	4	Urethan
⑯	Distanzhülse / Lock Spacer	2	Q235
⑰	Gasdruckfeder / Gas Spring	1	Typ / Type

Options-Code / Option Code	Beschreibung / Envelope
K	Passfeder ist montiert / Dedicated key is attached

Bestellnummer / Order Number

☎	Bestellnr. / Catalog No.	(W)	(α)	Typ / Type
	KDMVC	330	20	GK
	KDMVC	330	20	SC10

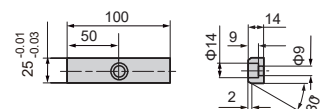
 Ausführung Passfeder /
Key specification

KDMVC400

Tabelle Schieber

Table of Cam Structure

Bestellnr. / Catalog No.	W	X ₁	X ₂	Z ₁	Z ₂	Gewicht (kg) / Weight (kg)
KDMVC400-00	400	395	50	219.9	341	345
KDMVC400-05	400	394.2	75	208.1	325.67	341
KDMVC400-10	400	392.94	95	190.9	314.68	348
KDMVC400-15	400	391.09	110	174.6	302.08	355
KDMVC400-20	400	393.52	125	164.2	282.93	366



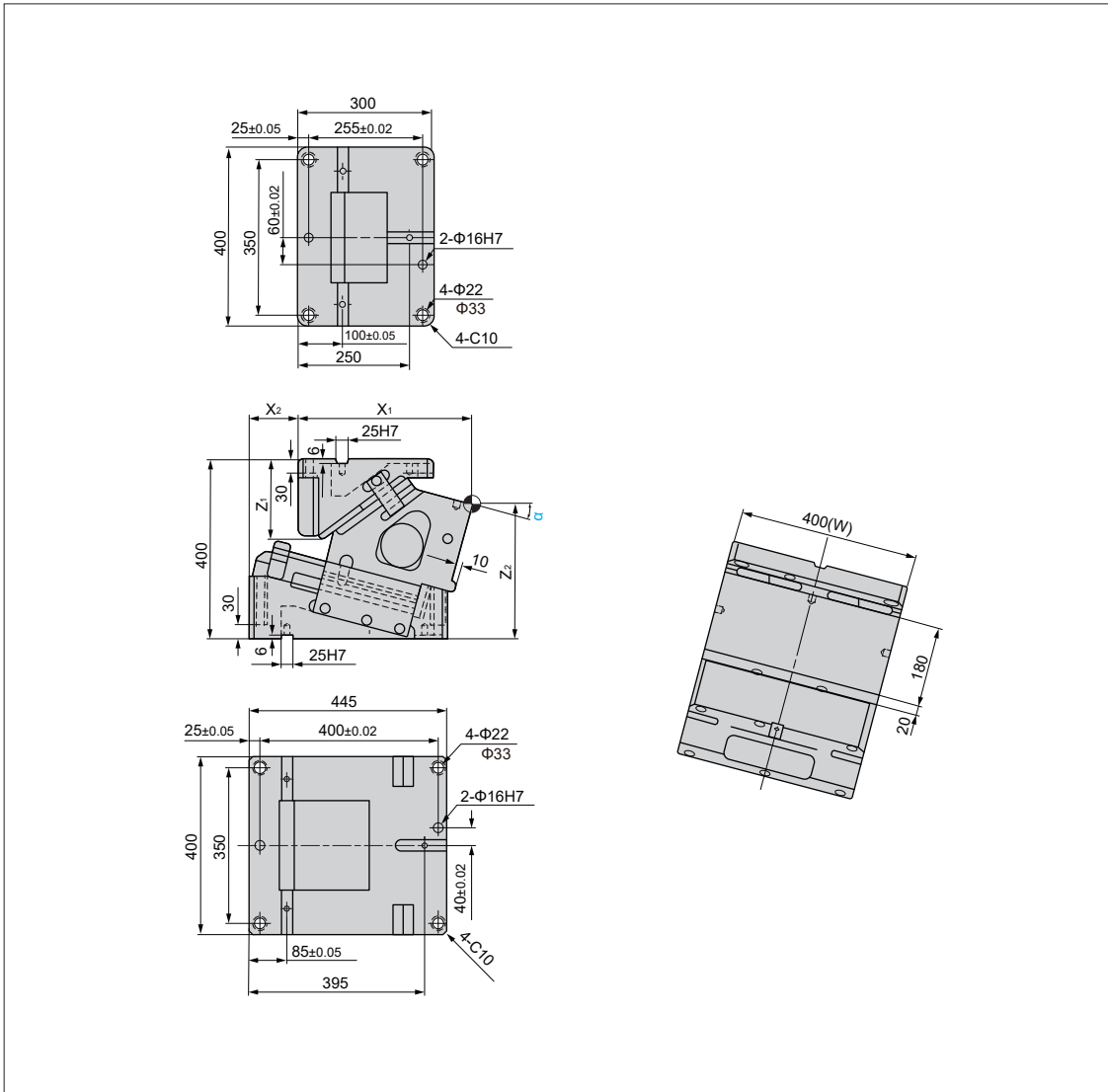
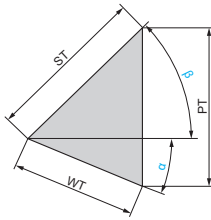

Bestellnr. / Catalog No.	α	β	WT	ST	PT
KDMVC400-00	0	50	80	124.5	95.3
KDMVC400-05	5	45	80	112.7	86.7
KDMVC400-10	10	40	80	102.8	80
KDMVC400-15	15	35	80	94.3	74.8
KDMVC400-20	20	30	80	86.8	70.8

**Übersicht Schieberkraft / Rückzugskraft
Table of Cam Force**

Typ / Type	α	Federkraft (kN/kp) / Spring Force (KN / kgf)		Arbeitskraft (kN / tonF) / (KN / tonF) Work Force	
		Anfangskraft / Initial Load	Endkraft / Final Load	1 Mio. Hübe / strokes Standard-Arbeitskraft / Standard Working Force	Gasdruckfeder / Gas Spring
GK	00° ~ 20°	14.8 / 1510	22 / 2243	431.5 / 44.0	K750-100 (KALLER)
CS	00° ~ 20°	15 / 1530.6	24.5 / 2500		SM.750.100 (SANKYO)
GD	00° ~ 20°	14.8 / 1510	22 / 2243		90.3.00750.100 (DADCO)

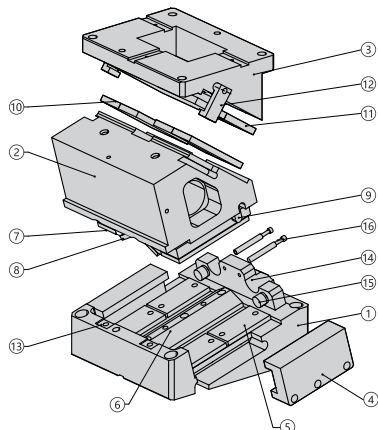

Nr. / No.	Beschreibung / Description	Anzahl / Qty	Material und Anmerkung / Material and Remark
①	Aufnahme / Cam Holder	1	QT550
②	Schieber / Cam Slider	1	QT550
③	Treiber / Cam Driver	1	QT550
④	Führungsleiste / Side Plate	1	St45
⑤	Gleitplatte / Guide Block	4	42CrMo
⑥	V-Prisma / V Guide Block	1	St45
⑦	Gleitplatte / Guide Block	2	Bronze+Festschmierstoff / graphite plugs
⑧	Gleitplatte / Guide Block	2	Bronze+Festschmierstoff / graphite plugs
⑨	Federblock / Spring Block	2	St45
⑩	Gleitplatte / Guide Block	4	42CrMo
⑪	Gleitplatte / Guide Block	4	Bronze+Festschmierstoff / graphite plugs
⑫	Zwangsrückführung / Positive Return Follower	2	St45
⑬	Federblock / Spring Block	2	St45
⑭	Anschlagblock / Stop Block	1	St45
⑮	Urethan-Dämpfer / Urethane Stopper	4	Urethan
⑯	Distanzhülse / Lock Spacer	2	Q235
⑰	Gasdruckfeder / Gas Spring	1	Typ / Type

Bestellnummer / Order Number

Bestellnr. / Catalog No. -
 (W) -
 (α) -
 Typ / Type
KDMVC 400 20 GK

 Ausführung Passfeder /
Key specification
