

**101 Mini Cam™**

Bestellbeispiel / Order example	
Schnellwechselstempel / Ball lock punches	<p>Schieber Nr. / Cam No</p> <p>Aufnahme Ø Stempel / Body Diam. Punch</p> <p>101 - B - 375</p> <p>= Schnellwechselstempel / Ball Lock Retainer</p>
Stempel m. Kopf / Headed punches	<p>Schieber Nr. / Cam No</p> <p>Länge Halterung / Length of retainer</p> <p>102 - H - 1250</p> <p>= Halter f. Stempel m. Kopf / Headed punch retainer</p>

Bestellnr. / Order No			Technische Daten / Technical Informations						
Standard Schieber / Cam	mit Stempelhalterung / with punch retainer		Durchm. / Diam. Inch / mm	Arbeitsweg / Work travel Inch / mm	Arbeitskraft / Working load ton / kN	Federkraft / Spring force lbs / N	Werkzeug- gewicht / Tooling weight max.	Schieberge- wicht / Cam weight lbs / kg	Bestellnr. Feder / Spring order no
	Stempel m. Kopf / Headed punch	Schnellwechsel Stempel / Ball lock punch							
101 (Inch)	101H0875	101B250	1,25	0,75	2	140	2	8	9-1012-26
	101H1125	101B375							
	101H1375	-							
101MM (metrisch)	101H0875MM	101B250MM	31,75	19,05	17,8	24,5	0,91	3,63	
	101H1125MM	101B375MM							
	101H1375MM	-							
102 (Inch)	102H1000	102B250	1,5	1	3	308	2	12	
	102H1250	102B375							
	102H1500	102B500							
102MM (metrisch)	-	102B625	38,1	25,4	26,7	53,9	0,91	5,44	9-1214-26
	102H1000MM	102B250MM							
	102H1250MM	102B375MM							
	102H1500MM	102B500MM							
	-	102B625MM							

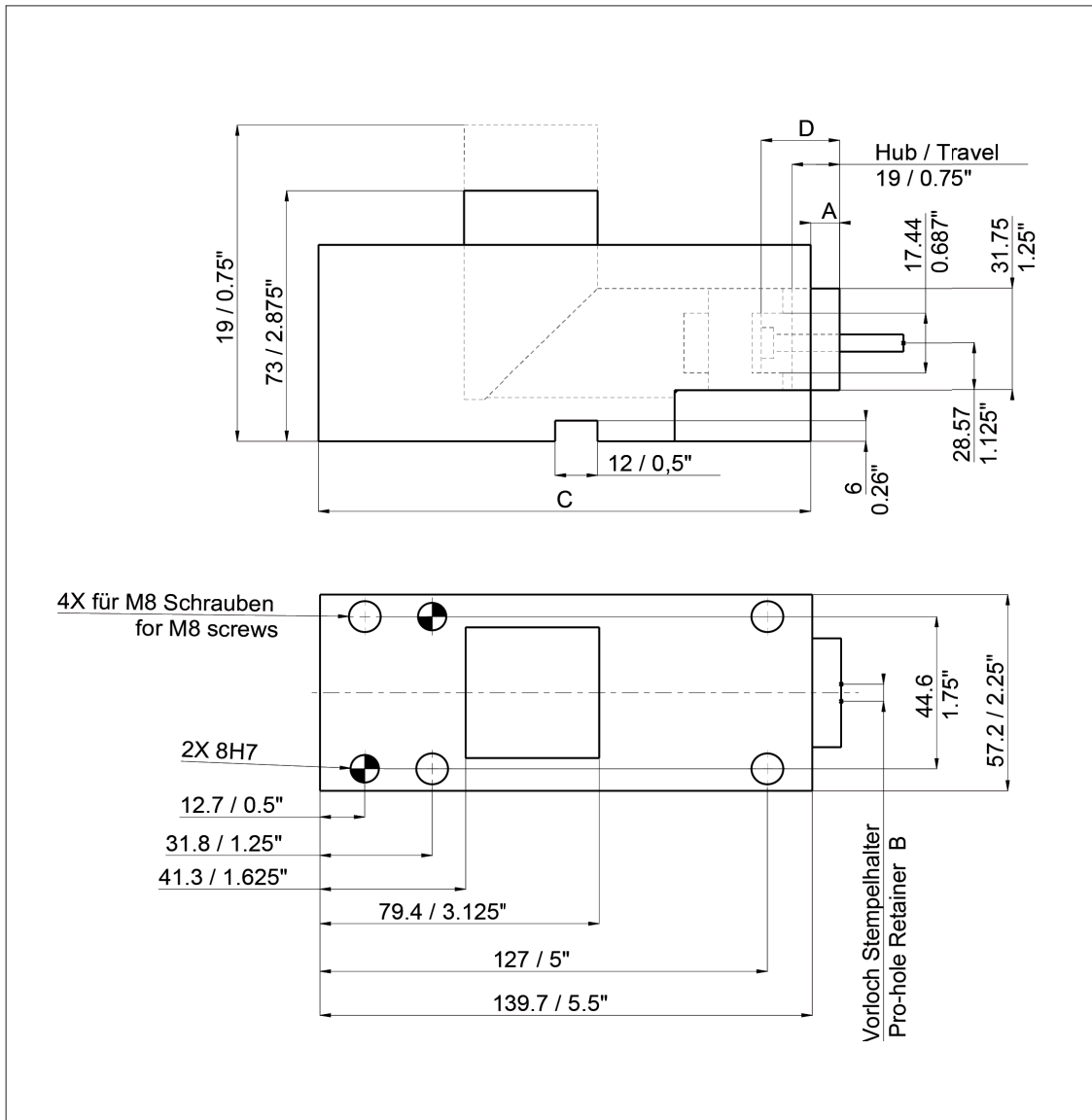

**101 / 101 MM Type**

Bestellnr. m. Stempelhalter / Order No with retainer	A Inch / mm	B Inch / mm	C Inch / mm	D Inch / mm	Stempel m. Kopf / Headed punch Inch / mm	Schnellwechsel- stempel / Ball lock punch Inch / mm
101H0875	3/8	0,1884	5-7/8	0,875	3/16 - 3/8	
101H0875MM	9,5	4,79	149,2	22,2	5 - 10	
101H1125	5/8	0,1884	6-1/8	1,125	3/16 - 3/8	
101H1125MM	15,9	4,79	155,6	28,6	5 - 10	
101H1375	7/8	0,1884	6-3/8	1,375	3/16 - 3/8	
101H1375MM	22,2	4,79	161,9	34,9	5 - 10	
101B250	11/16	0,2503	6-3/16	1		1/4
101B250MM	17,5	6,36	157,2	25,4		6
101B375	11/16	0,375	6-3/16	1		3/8
101B375MM	17,5	9,53	157,2	25,4		10

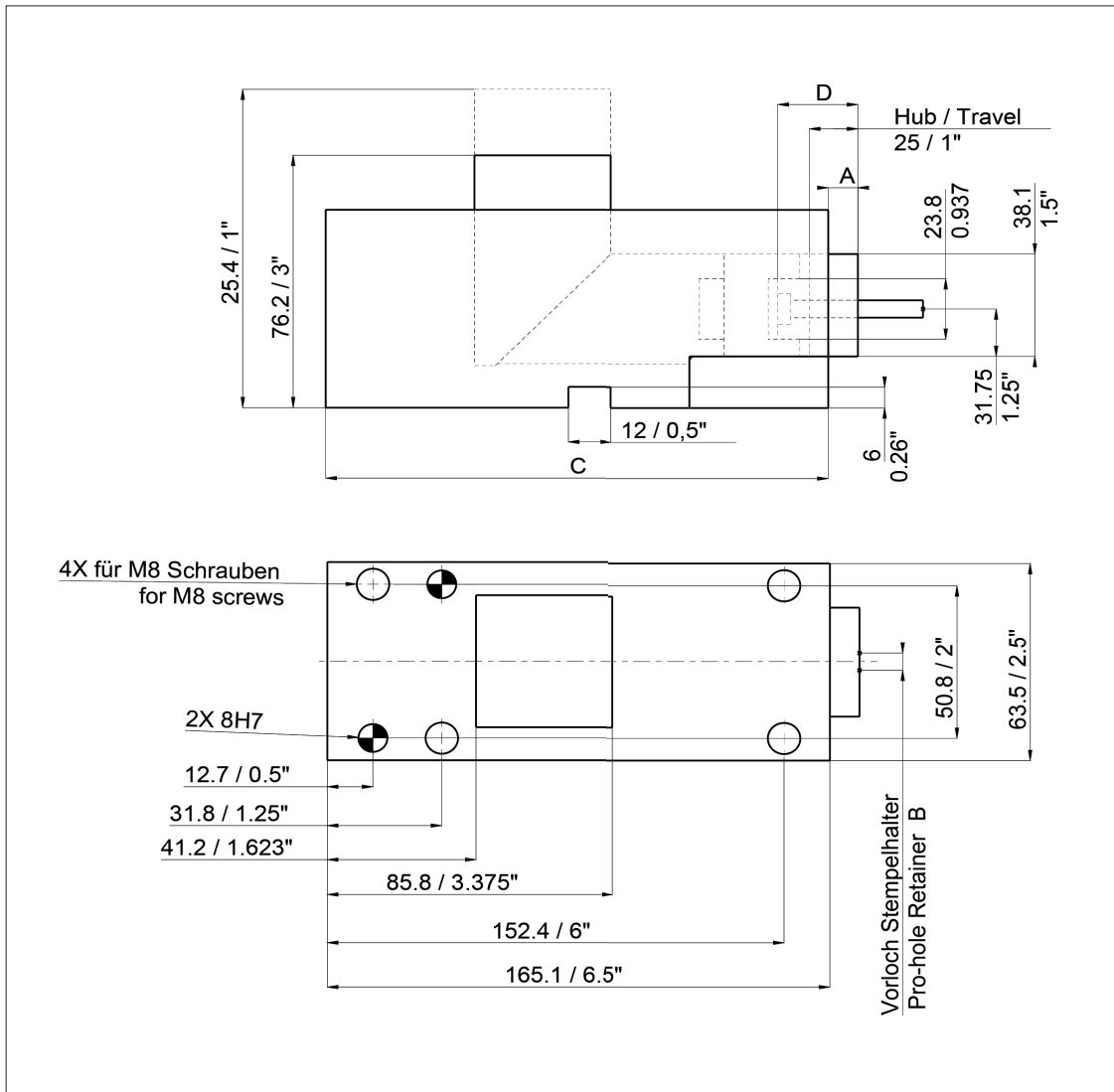

**102 / 102 MM Type**

Bestellnr. m. Stempelhalter / Order No with retainer	A Inch / mm	B Inch / mm	C Inch / mm	D Inch / mm	Stempel m. Kopf / Headed punch Inch / mm	Schnellwechsel- stempel / Ball lock punch Inch / mm	
102H1000	1/4	0,25	6-3/4	1	1/4 - 5/8		
102H1000MM	6,35	6,37	171,5	25,4	6 - 16		
102H1250	1/2	0,25	7	1,25	1/4 - 5/8		
102H1250MM	12,7	6,37	177,8	31,8	6 - 16		
102H1500	3/4	0,25	7-1/4	1,5	1/4 - 5/8		
102H1500MM	19	6,37	184,2	38,1	6 - 16		
102B250	1/2	0,25	7	1			1/4
102B250MM	12,7	6,37	177,8	25,4			6
102B375	1/2	0,375	7	1			3/8
102B375MM	12,7	9,53	177,8	25,4			10
102B500	1/2	0,5	7	1			1/2
102B500MM	12,7	12,7	177,8	25,4			12
102B625	1/2	0,625	7	1			5/8
102B625MM	12,7	15,88	177,8	25,4			16

